

Lay the touch screen face down on the floor. Gripping the black handle pull the support bar away from the base.

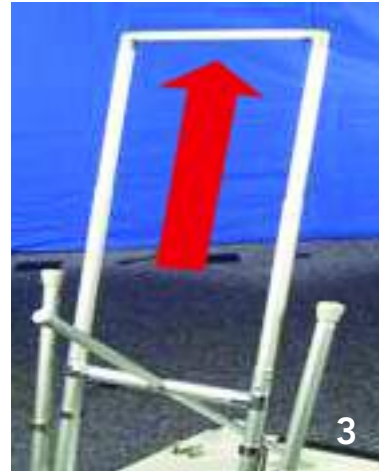

Remove the keypad, headset and power cord from the back.



Continue pulling the inside legs all the way up.



Check to make sure you see four safety pins snap into place.

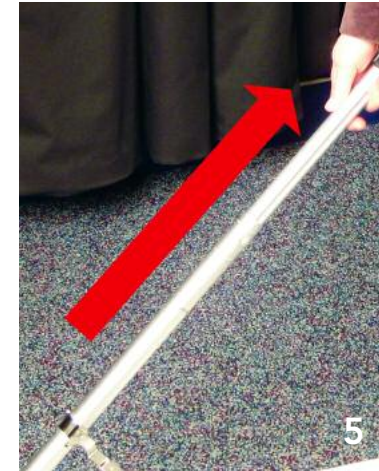

Grip the outside legs and pull up until the safety pin on each leg locks into place.



Pull the outside legs away from the base making sure the bracket is fully extended and locked.



Carefully stand the unit up. To adjust the angle, lift up on the handle while pressing the safety pin on the support bar.



Daisy chain the units together by taking the power cord from the first unit and plugging it into an outlet.



Take the male end of the next TS cord and plug it into the empty spot in the first unit.



Continue plugging all the units in. The last unit will have one empty plug.



Set up one VIBS unit by pressing on the black notch while pulling the tablet forward.



Pull the tablet out of the cradle and plug the keypad into the port on the back.

# AccuVote TSX™ Quick Reference Guide – Opening Poll



13 Feed the cord through mounting slot.



14 Set the keypad aside.



15 Plug the headphones into the jack on the front of the tablet.



16 To install the AccuView Printer Module, see the separate Installation Guide, then proceed to the next step.



17 Close the memory card door.



18 Insert the VAC into the encoder with the gold chip facing you and press "on".



19

Choose the ballot style by pressing the number that corresponds and press YES when you see CREATE?



20

When the encoder reads CLEAR?, remove the card.



21

To encode an audio ballot, at the create screen press the \* twice and VMCREATE? will show.



## Start



1 Insert the key. Unlock and raise the AVPM cover.



2 Insert the supervisor card and enter the password.

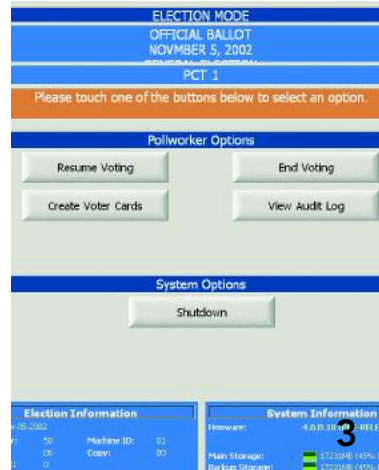

3 Remove the supervisor card and press End Voting.

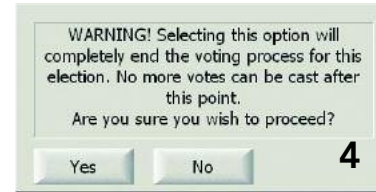

4 Select YES at the warning screen.

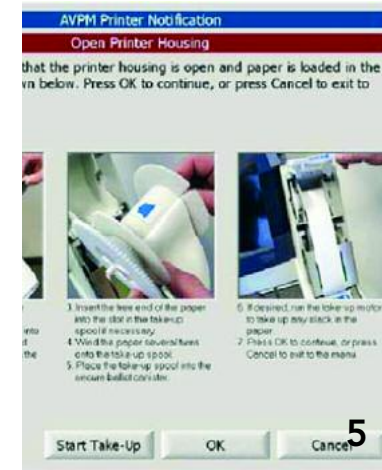

5 When the printer notification appears, press OK.



6 For SINGLE precincts, when you see the message "PRINT WRITE-IN CANDIDATES?" press NO. For MULTIPLE precincts refer to the poll worker manual.



7 For SINGLE precincts, when you see the message "PRINT LONG REPORT?", press YES. For MULTIPLE precincts refer to the poll worker manual.



8 All poll workers need to sign the totals report and rip it off with the canister. Manually wind the report into the canister.

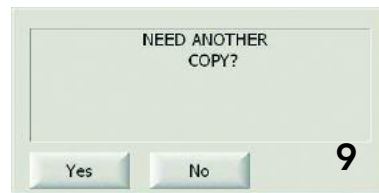

9 When the message "NEED ANOTHER COPY?" appears, press YES. Press OK to print. When "NEED ANOTHER COPY" appears, continue to press yes until you have the required number of copies. Once you have all required copies, press NO.

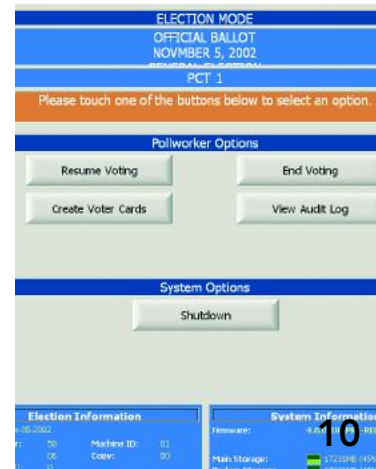

10 Sign and rip off the report. Place the report in the memory card pouch. Press Shutdown. Press YES to confirm.



11 Lift printer housing and remove the paper roll.



12 Unlock the AVPM by pulling the blue lever towards you. Close printer housing.

# AccuVote TSX™ Quick Reference Guide – Closing Poll



13 Pull the white latch towards you.



14 Gently take off the AVPM. Close the printer door and lock it.



15 Close the privacy panels on the unit and seal them with a security seal. Disconnect headset, keypad and power cord from the tablet. Remove keypad from mounting slot. Close privacy screen.



16 Collapse inner leg by depressing both sets of safety pins and pushing down.

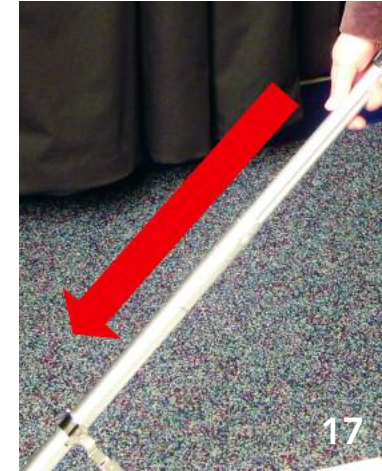

17 Collapse outside legs by depressing the safety pins on each leg and pushing down.



18 Carefully collapse the bracket by pushing down in the middle. Fold the outer legs in until even with inner legs.



19 Collapse leg assembly by depressing safety pin on base support strut and pushing support bar down toward the base.



20 Replace power cord, keypad, and headset on their respective storage brackets.