

U.S. DEPARTMENT OF THE INTERIOR  
BUREAU OF LAND MANAGEMENT

LAND DESCRIPTION DIAGRAM

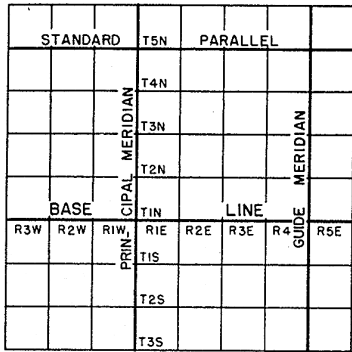

Diagram showing division of tract into Townships

36	31	32	33	34	35	36	31
1	6	5	4	3	2	1	6
12	7	8	9	10	11	12	7
13	18	17	16	15	14	13	18
24	19	20	21	22	23	24	19
25	30	29	28	27	26	25	30
36	31	32	33	34	35	36	31
1	6	5	4	3	2	1	6

Sectional map of Township showing adjoining Sections

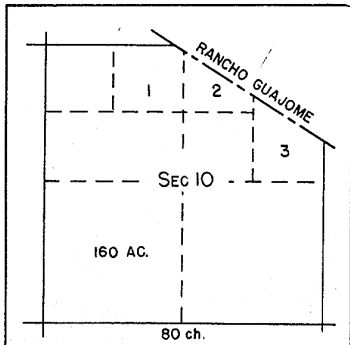
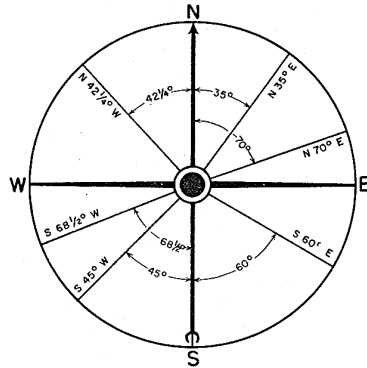
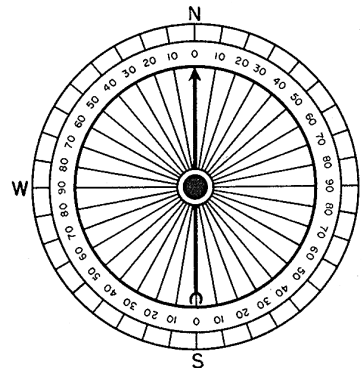

Diagram illustrating division of Fractional Section into Government Lots



60 seconds equal one minute  
60 minutes equal one degree



90 degrees in a right angle  
360 degrees in a circle

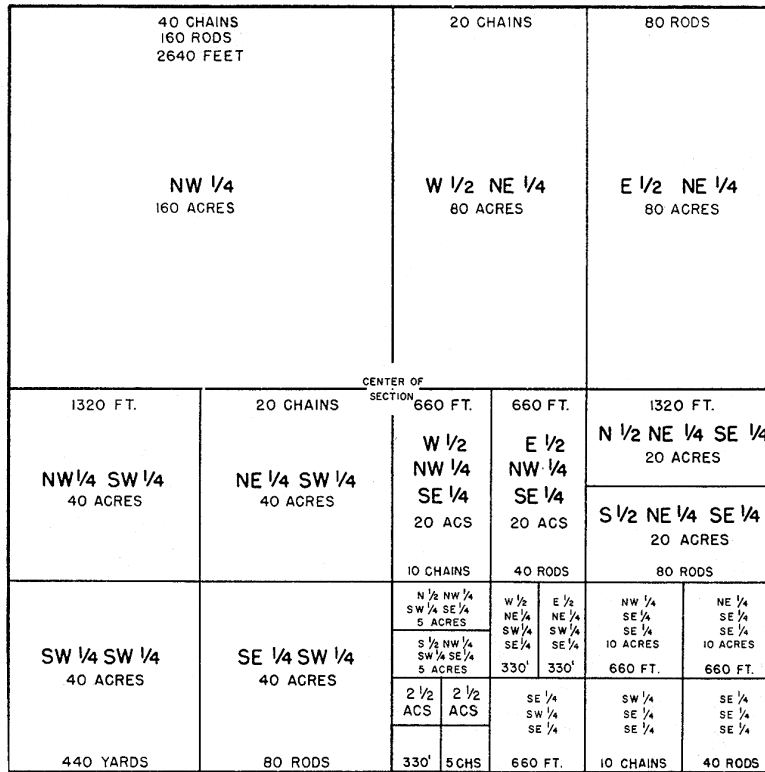

Table of Land Measurements

LINEAR MEASURE

1 inch =	.0833 ft.
7.92 inches =	1 link
12 inches =	1 foot
1 vara =	33 inches
2 3/4 feet =	1 vara
3 feet =	1 yard
25 links =	16 1/2 feet
25 links =	1 rod
100 links =	1 chain
16 1/2 feet =	1 rod
5 1/2 yards =	1 rod
4 rods =	100 links
66 feet =	1 chain
80 chains =	1 mile
320 rods =	1 mile
8000 links =	1 mile
5280 feet =	1 mile
1760 yards =	1 mile

SQUARE MEASURE

144 sq. in. =	1 sq. foot
9 sq. feet =	1 sq. yard
30 1/2 sq. yds. =	1 sq. rod
16 sq. rods =	1 sq. chain
1 sq. rod =	272 1/4 sq. ft.
1 sq. ch. =	4356 sq. ft.
10 sq. chs. =	1 acre
160 sq. rods =	1 acre
4840 sq. yds. =	1 acre
43560 sq. ft. =	1 acre
640 acres =	1 sq. mile
1 sq. mile =	1 section
36 sq. miles =	1 Twp.
6 miles sq. =	1 Twp.
1 sq. mi. =	2.59 sq. kilm

An Acre is:

43,560 sq. feet.	660 feet x 66 feet.
165 feet x 264 feet.	160 square rods.
198 feet x 220 feet.	208' 8" square.

or any rectangular tract, the product of the length and width of which totals 43,560 sq. ft.