

PROJECT	DESIGNATION
1801032	1801032
CONTRACT	BRIDGE FILE
B-41458	N/A

CULVERT ASSETS	
DES. NO.	CULVERT ASSET ID
1801032	CV 135-036-75.70

KIN PROJECT INFORMATION	
DESIGNATION	PROJECT DESCRIPTION
1800228	SR 258 OVER BEATTY WALKER DITCH SUPERSTRUCTURE REPLACEMENT, 6.10 MILES EAST OF SR 58
1800287	SR 135 OVER BRANCH KIPER CREEK SUPERSTRUCTURE REPLACEMENT, 2.68 MILES NORTH OF SR 58.
1800292	SR 258 OVER LITTLE SALT CREEK SUPERSTRUCTURE REPLACEMENT, 0.99 MILES EAST OF SR 58.
1801011	SR 258 OVER UNT TO SPRAY CREEK SMALL STRUCTURE REPLACEMENT, 2.25 MILES EAST OF SR 58.
1801032	SR 135 OVER UNT TO KIPER CREEK SMALL STRUCTURE REPLACEMENT, 1.05 MILES NORTH OF SR 58.
1801047	SR 58 OVER UNT TO WHITE CREEK SMALL STRUCTURE REPLACEMENT, 9.66 MILES EAST OF SR 258
1801048	SR 58 OVER UNT TO SALT CREEK SMALL STRUCTURE REPLACEMENT, 4.19 MILES WEST OF SR 135

INDIANA DEPARTMENT OF TRANSPORTATION



ROAD PLANS

ROUTE: S.R. 135 AT: RP 75+70

PROJECT NO. 1801032 P.E.
1801032 R/W
1801032 CONST.

SMALL STRUCTURE REPLACEMENT ON S.R. 135 OVER U.N.T. TO KIPER CREEK APPROXIMATELY 1.05 MILES NORTH OF S.R. 58 IN SECTION 1, T-6-N, R-3-E, PERSHING TOWNSHIP, JACKSON COUNTY, INDIANA

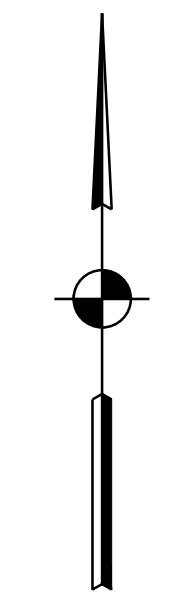
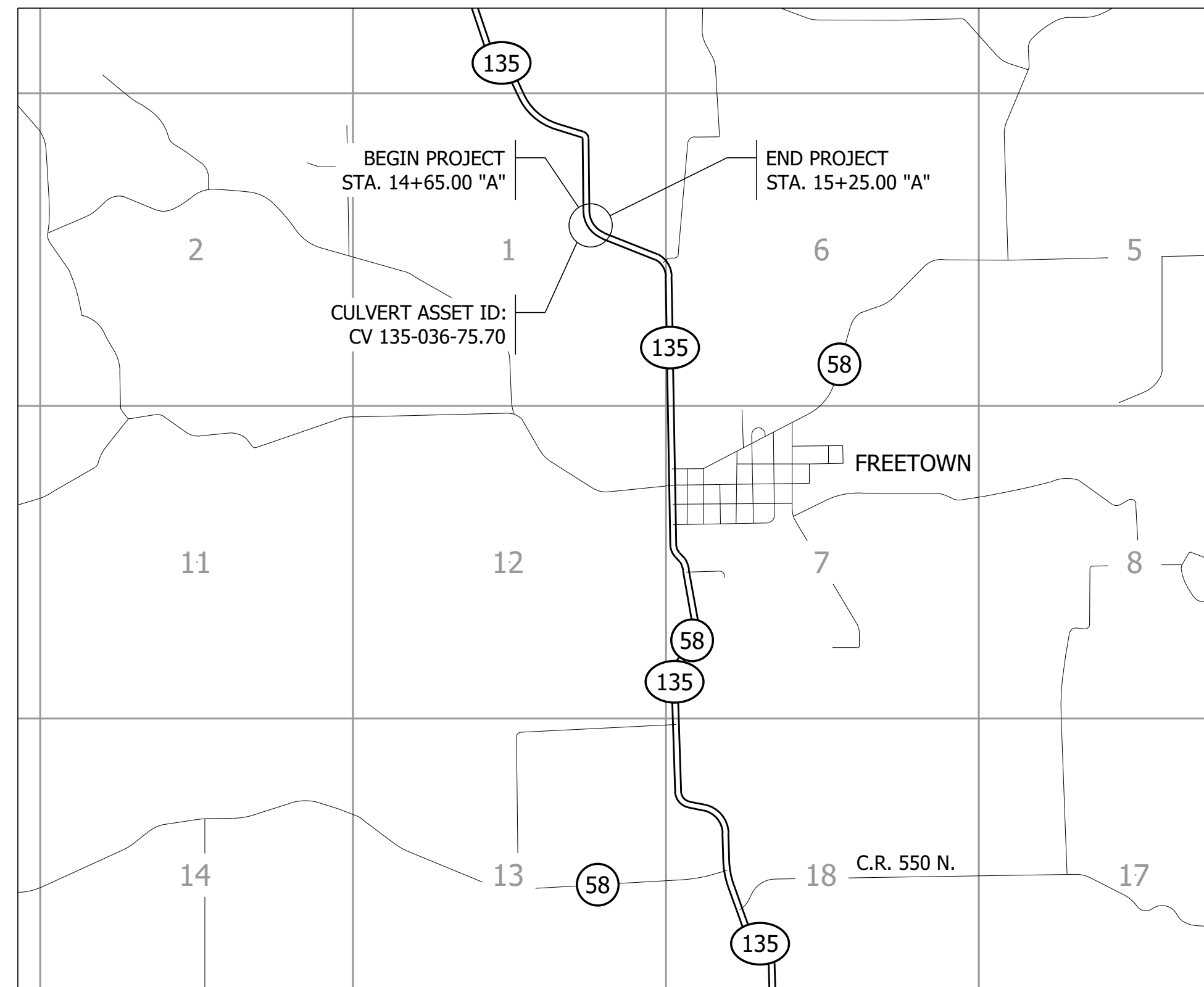

SCALE: 1" = 2000'

STAGE 2 PLANS
SEPTEMBER 4, 2020

TRAFFIC DATA	S.R. 135
A.A.D.T. (2023)	565 V.P.D.
A.A.D.T. (2043)	604 V.P.D.
D.H.V. (2043)	65 V.P.H.
DIRECTIONAL DISTRIBUTION	52.61% NORTH
TRUCKS	10.17% D.H.V.
	11.17% A.A.D.T.
DESIGN DATA	
DESIGN SPEED	45 M.P.H.
PROJECT DESIGN CRITERIA	3R (NON-FREEWAY)
FUNCTIONAL CLASSIFICATION	MINOR ARTERIAL
RURAL/URBAN	RURAL
TERRAIN	LEVEL
ACCESS CONTROL	NONE

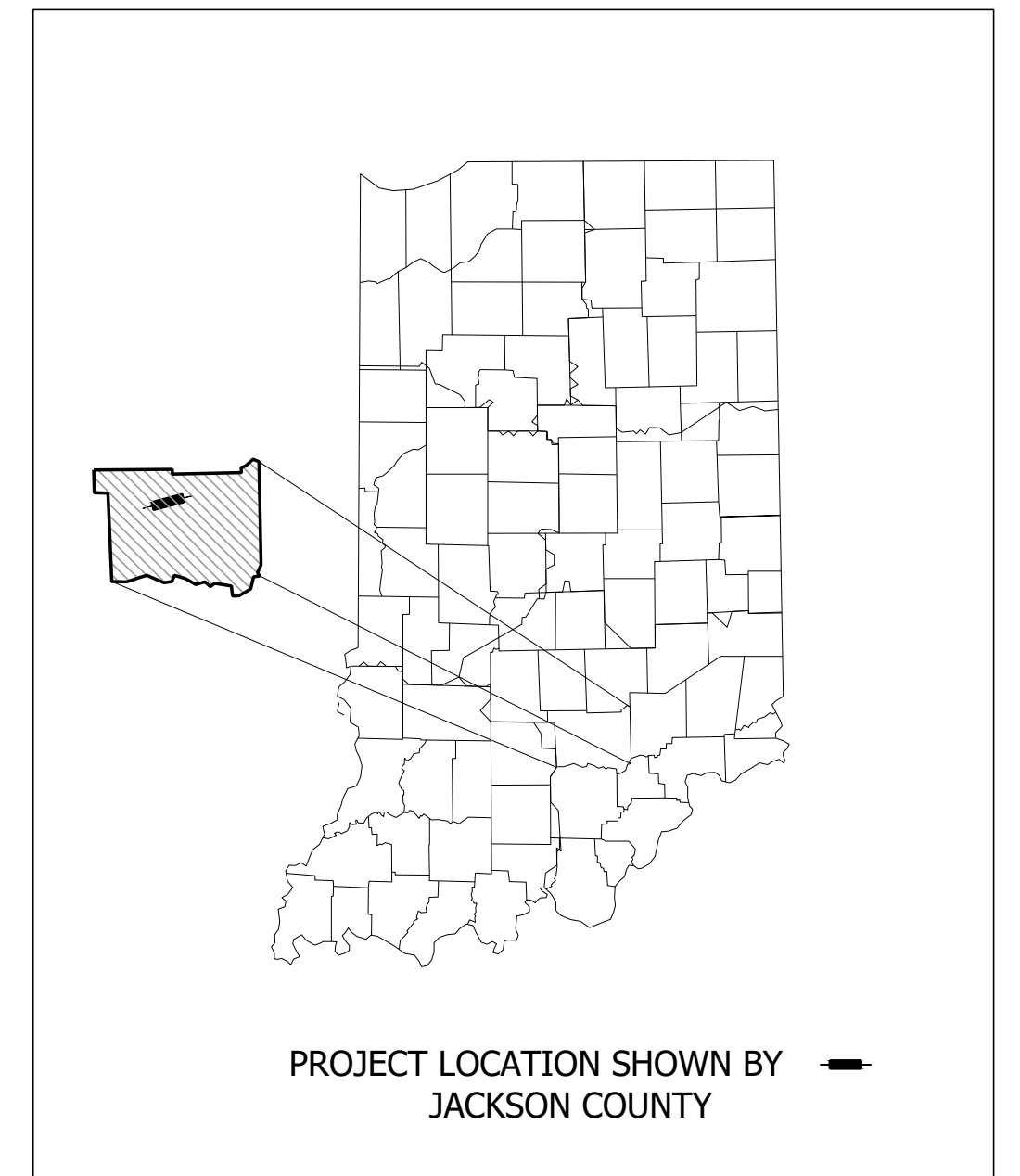

LATITUDE: 38°59'07" N LONGITUDE: 86°08'18" W

BRIDGE LENGTH:	0.000	MI.
ROADWAY LENGTH:	0.012	MI.
TOTAL LENGTH:	0.012	MI.
MAX. GRADE:	0.20%	%

HUC 14: 05120208060010



INDIANA DEPARTMENT OF TRANSPORTATION STANDARD SPECIFICATIONS DATED 2020 TO BE USED WITH THESE PLANS.

PRELIMINARY	PLANS PREPARED BY: CORRADINO, LLC	317-488-2363 PHONE NUMBER	BRIDGE FILE
	CERTIFIED BY: _____	_____ DATE	N/A
	APPROVED FOR LETTING: _____	_____ DATE	DESIGNATION
	INDIANA DEPARTMENT OF TRANSPORTATION	DATE	1801032
			SHEETS
			1 of 16
			CONTRACT
			B-41458
			PROJECT
			1801032

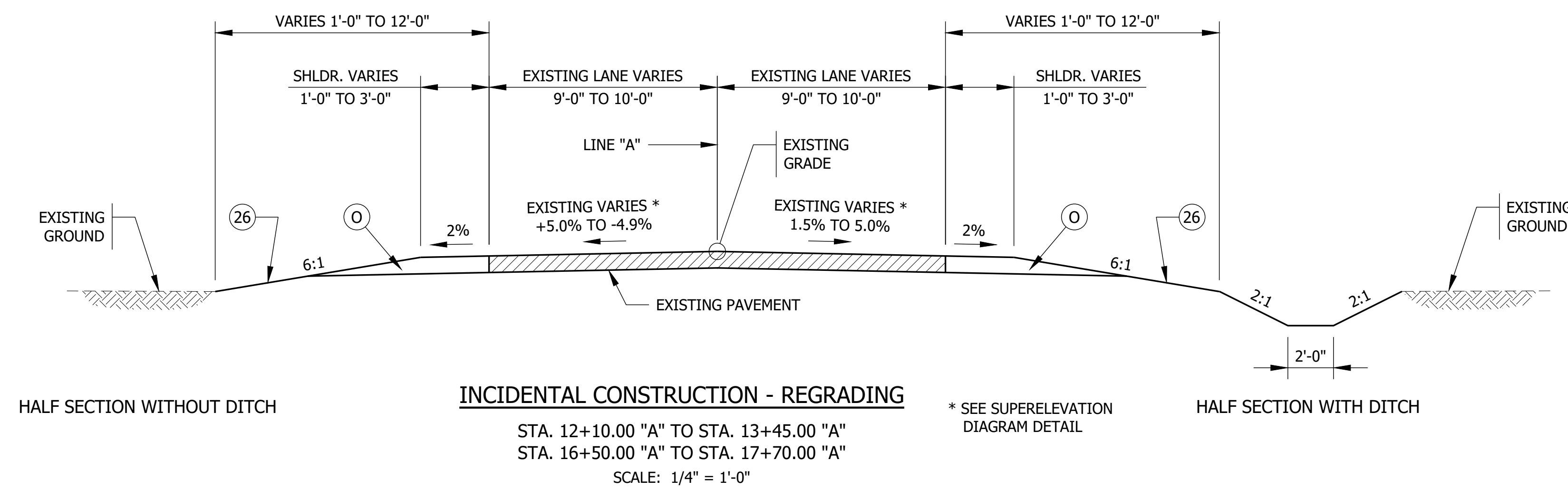
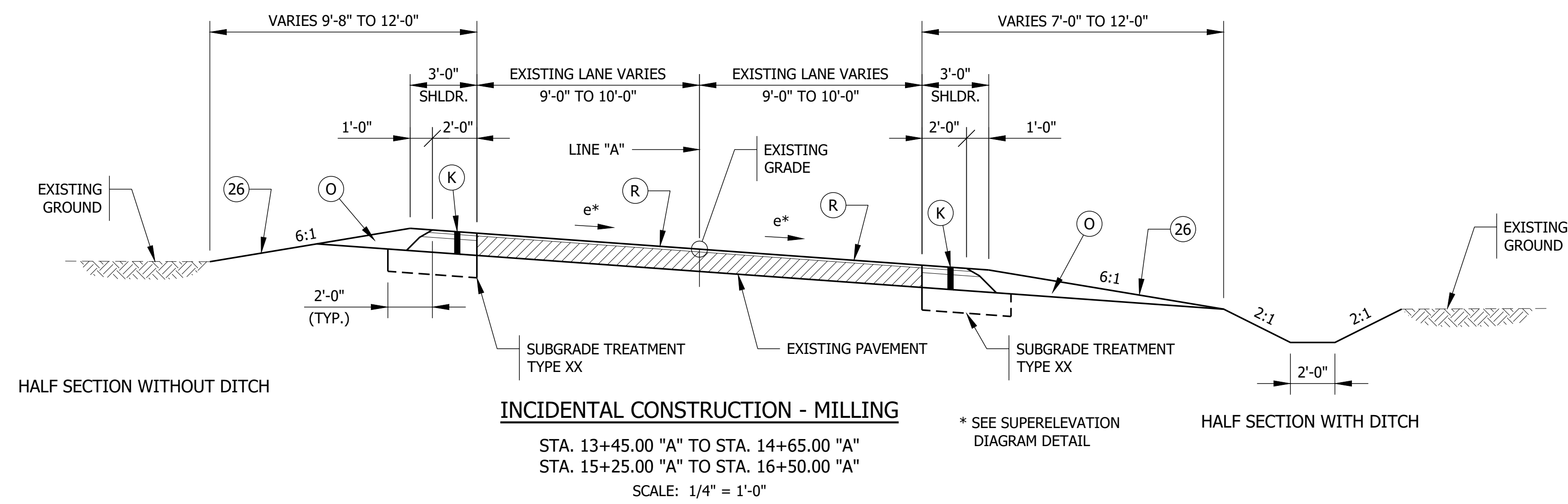
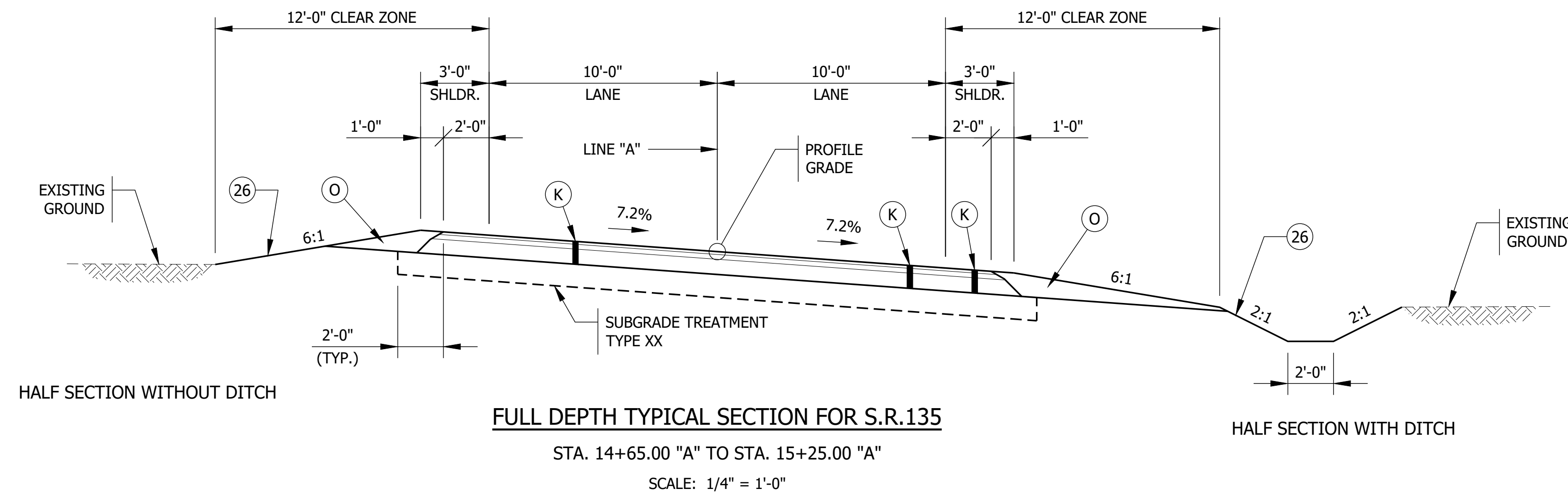

LEGEND

- (K) XXX/SYD QC/QA HMA, 3, 70, SURFACE, 9.5MM ON
 XXX/SYD QC/QA HMA, 3, 70, INTERMEDIATE, 19.0MM ON
 XXX/SYD QC/QA HMA, 3, 64, BASE, 25.0MM
- TACK COAT TO BE PLACED BETWEEN HMA LAYERS. JOINT ADHESIVE TO BE INSTALLED AT ALL LONGITUDINAL JOINTS IN THE SURFACE AND INTERMEDIATE LAYER. LIQUID ASPHALT SEALANT TO BE PLACED CENTERED ON THE LONGITUDINAL JOINTS THAT HAVE JOINT ADHESIVE INSTALLED.
- (O) XX" COMPACTED AGGREGATE, NO. 53
- (26) EROSION CONTROL BLANKET WITH SEED MIXTURE, R
- (R) GRADE CHANGE 0" TO 1.5":
 XXX LBS/SYD QC/QA HMA, 3, 70, SURFACE, 9.5MM ON
 TRANSITION MILLING
- GRADE CHANGE 1.5" TO 4":
 XXX LBS/SYD QC/QA HMA, 3, 70, SURFACE, 9.5MM ON
 XXX LBS/SYD QC/QA HMA, 3, 70, INTERMEDIATE, 19MM ON
 TRANSITION MILLING

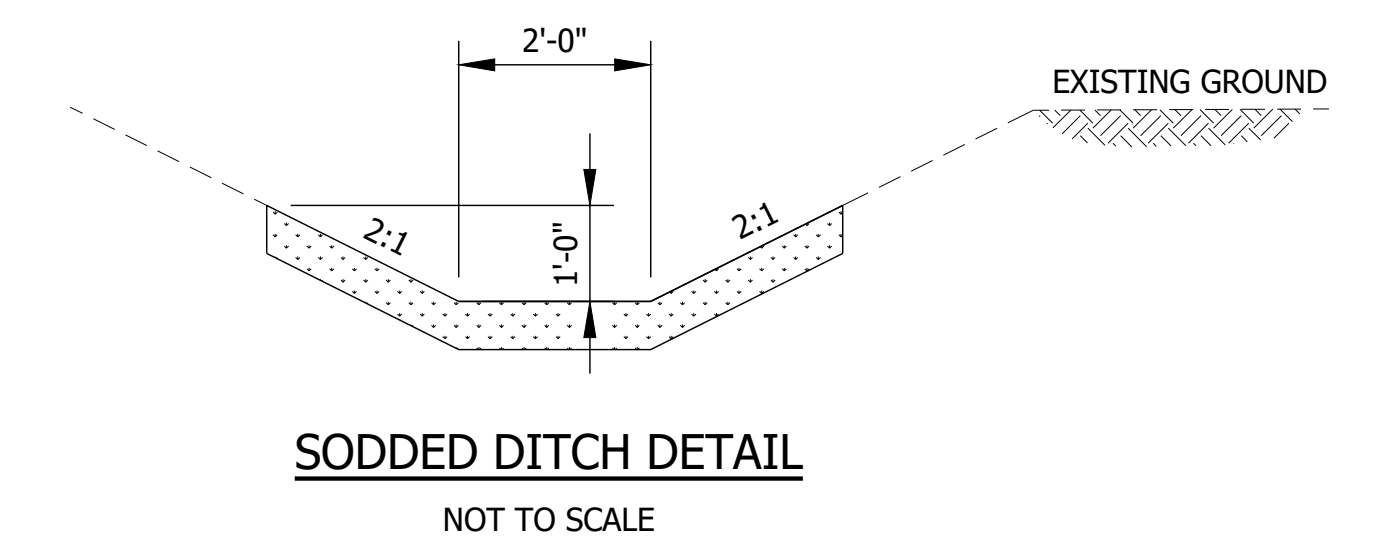
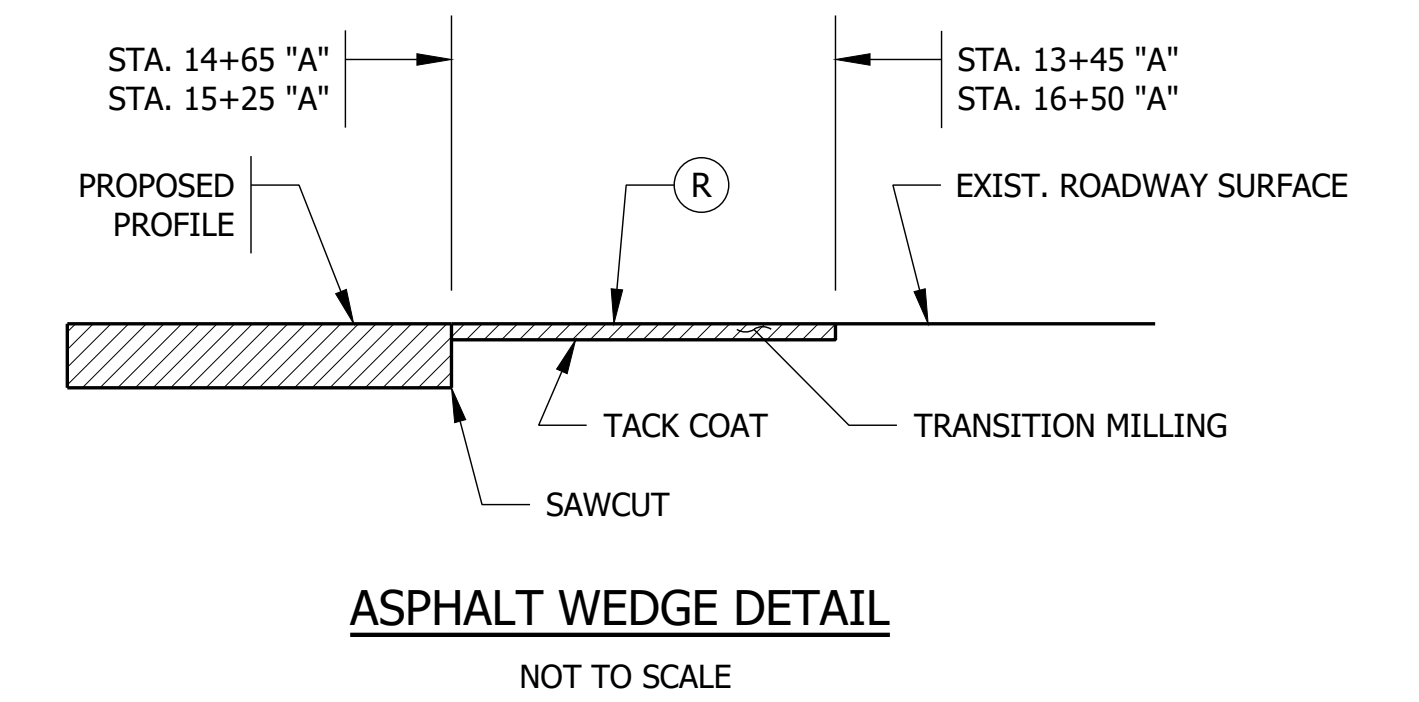
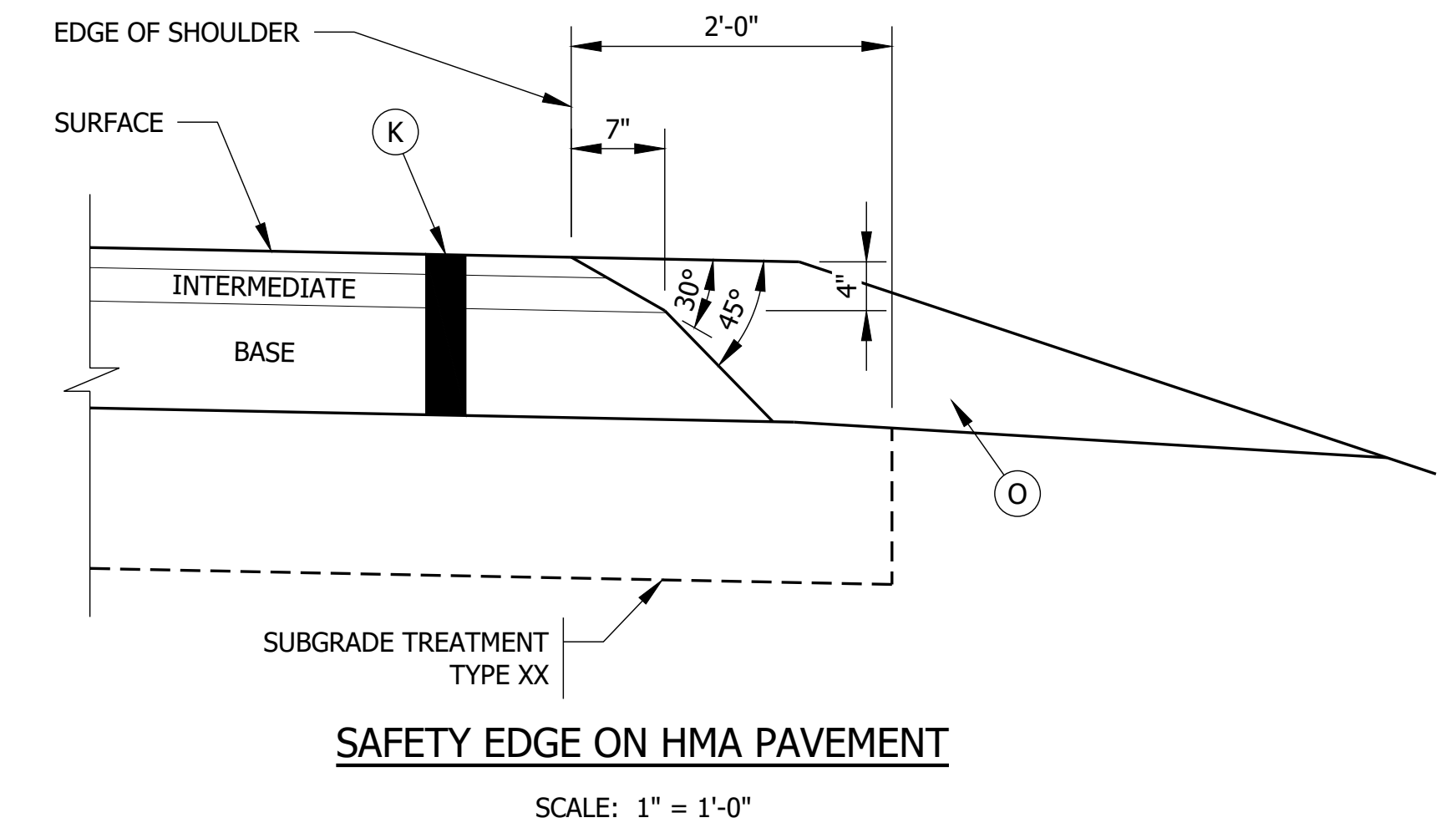

File Name: F:\4546-1801032_S.R135SmSrh50 Plans\30 Sheet Drawings\10 Bridge Sheets\S-TYP-SEC-01.dwg - Layout1
 August 10, 2020 11:09:16 AM / sbath
 September 4, 2020 2:23:50 PM / Stacey Johnson
 Modified / By:
 Plotted / By:

PRELIMINARY	RECOMMENDED FOR APPROVAL _____	INDIANA DEPARTMENT OF TRANSPORTATION	HORIZONTAL SCALE	BRIDGE FILE
	DESIGNED: ZZH		DRAWN: SEJ	AS NOTED
	CHECKED: BJM	CHECKED: ZZH	VERTICAL SCALE	DESIGNATION
			TYPICAL SECTIONS	
				SHEET
				3 of 16
				PROJECT
				1801032

File Name: F:\4546-1801032_SRR135SmStr50 Plans\30 Sheet Drawings\10 Bridge Sheets\PLAT-01.dwg - Layout1
 Modified / By: September 4, 2020 11:40:58 AM / sjohnson
 Plotted / By: September 4, 2020 2:24:03 PM / Stacey Johnson

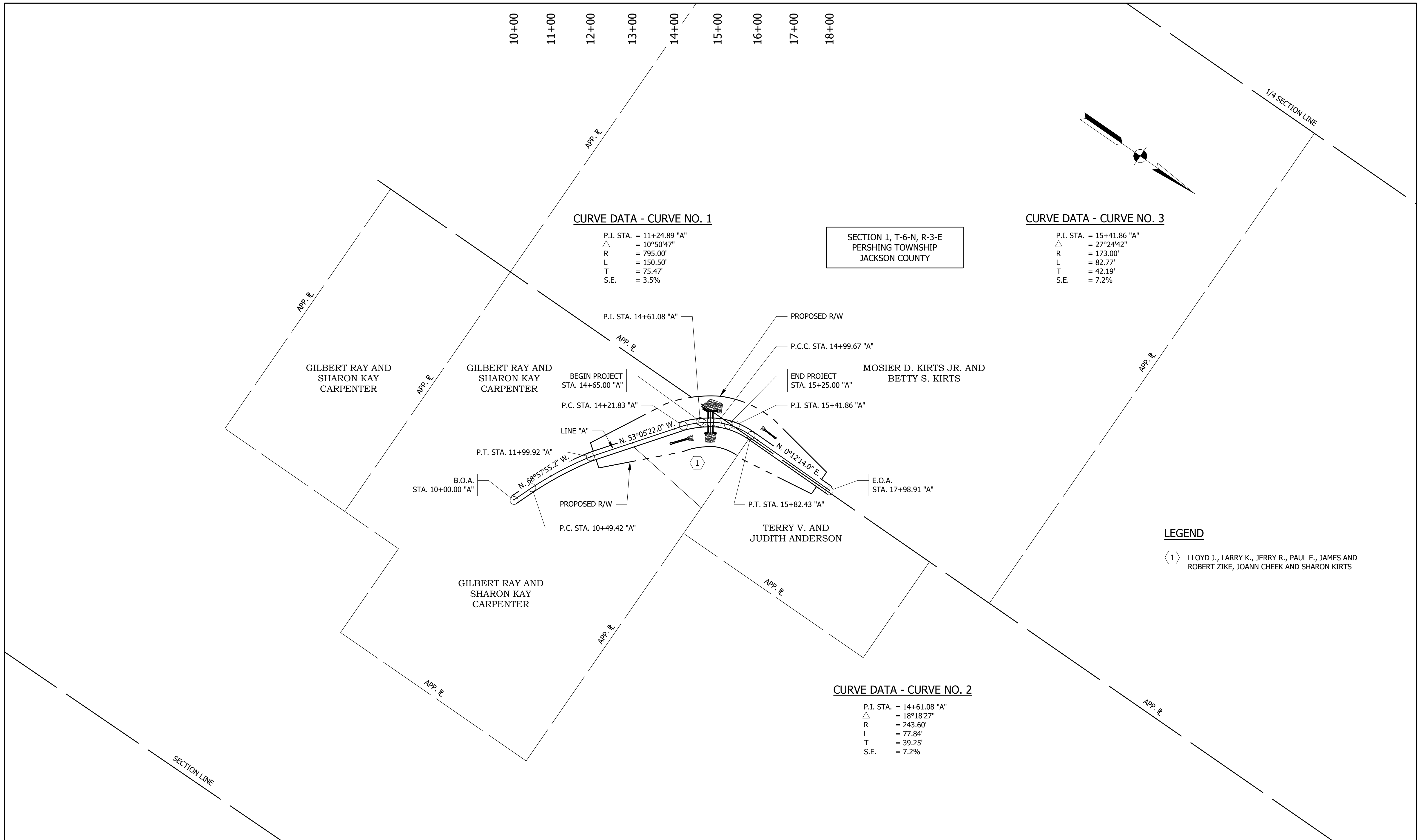

PRELIMINARY	RECOMMENDED FOR APPROVAL _____ DESIGN ENGINEER _____ DATE _____	INDIANA DEPARTMENT OF TRANSPORTATION PLAT NO. 1	HORIZONTAL SCALE 1" = 100' UNLESS NOTED VERTICAL SCALE	BRIDGE FILE N/A DESIGNATION 1801032
	DESIGNED: ZZH DRAWN: SEJ		SHEET 4 of 16	
	CHECKED: BJM CHECKED: ZZH		CONTRACT B-41458	
			PROJECT 1801032	

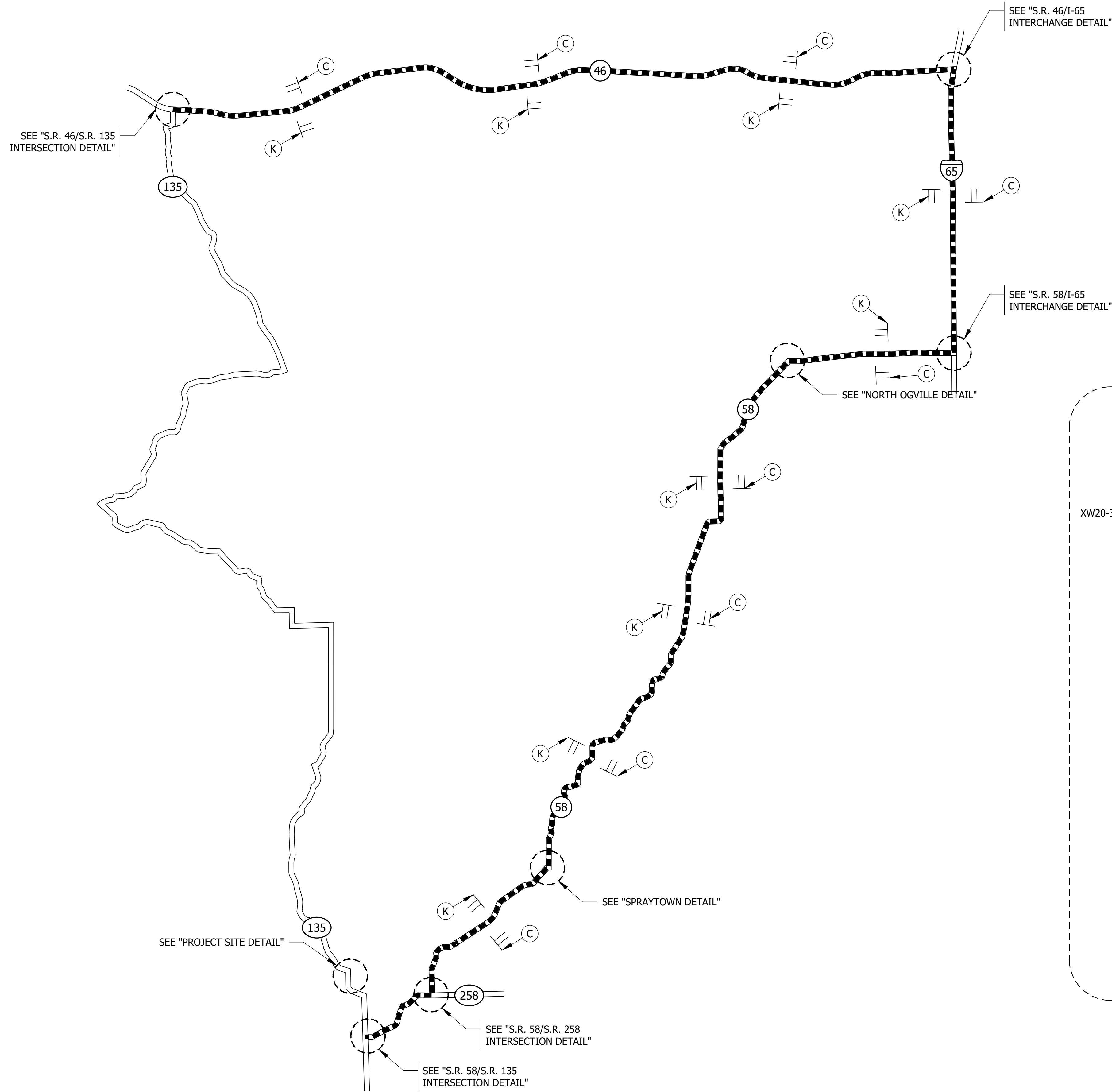
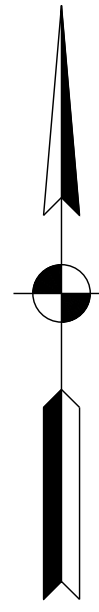

LEGEND

- ① 24 LFT. OF TYPE III-B BARRICADES, STAGGERED WITH ROAD CLOSURE SIGN ASSEMBLY R11-4.
- ② 24 LFT. OF TYPE III-A BARRICADES WITH ROAD CLOSURE SIGN ASSEMBLY R11-2.
- DETOUR ROUTE
- TT SIGN ASSEMBLY

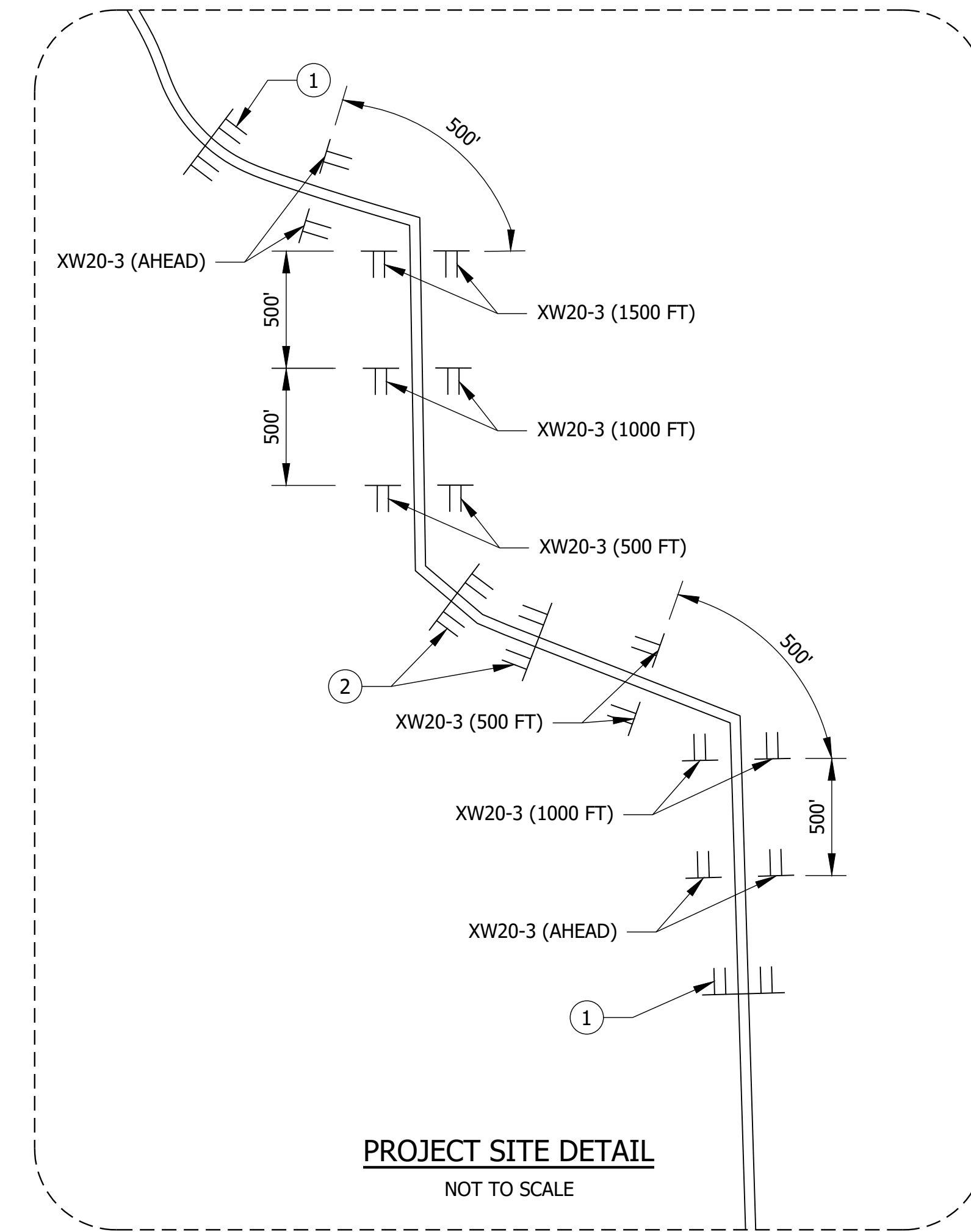

File Name: F:\4546-1801032_S.R.135\50 Plans\30 Sheet Drawings\10 Bridge Sheets\S-MOT-DETOUR-01.DWG - Layout1
 Modified / By: September 4, 2020 11:30:50 AM / sjohnson
 Plotted / By: September 4, 2020 2:24:11 PM / Stacey Johnson

PRELIMINARY	RECOMMENDED FOR APPROVAL _____ <small>DESIGN ENGINEER DATE</small>	INDIANA DEPARTMENT OF TRANSPORTATION MAINTENANCE OF TRAFFIC	HORIZONTAL SCALE 1" = 5000' UNLESS NOTED VERTICAL SCALE	BRIDGE FILE N/A DESIGNATION 1801032
	DESIGNED: SSB DRAWN: SEJ		SHEET 5 of 16	
	CHECKED: BJM CHECKED: SSB		PROJECT 1801032	
	<small>CONTRACT</small> B-41458			

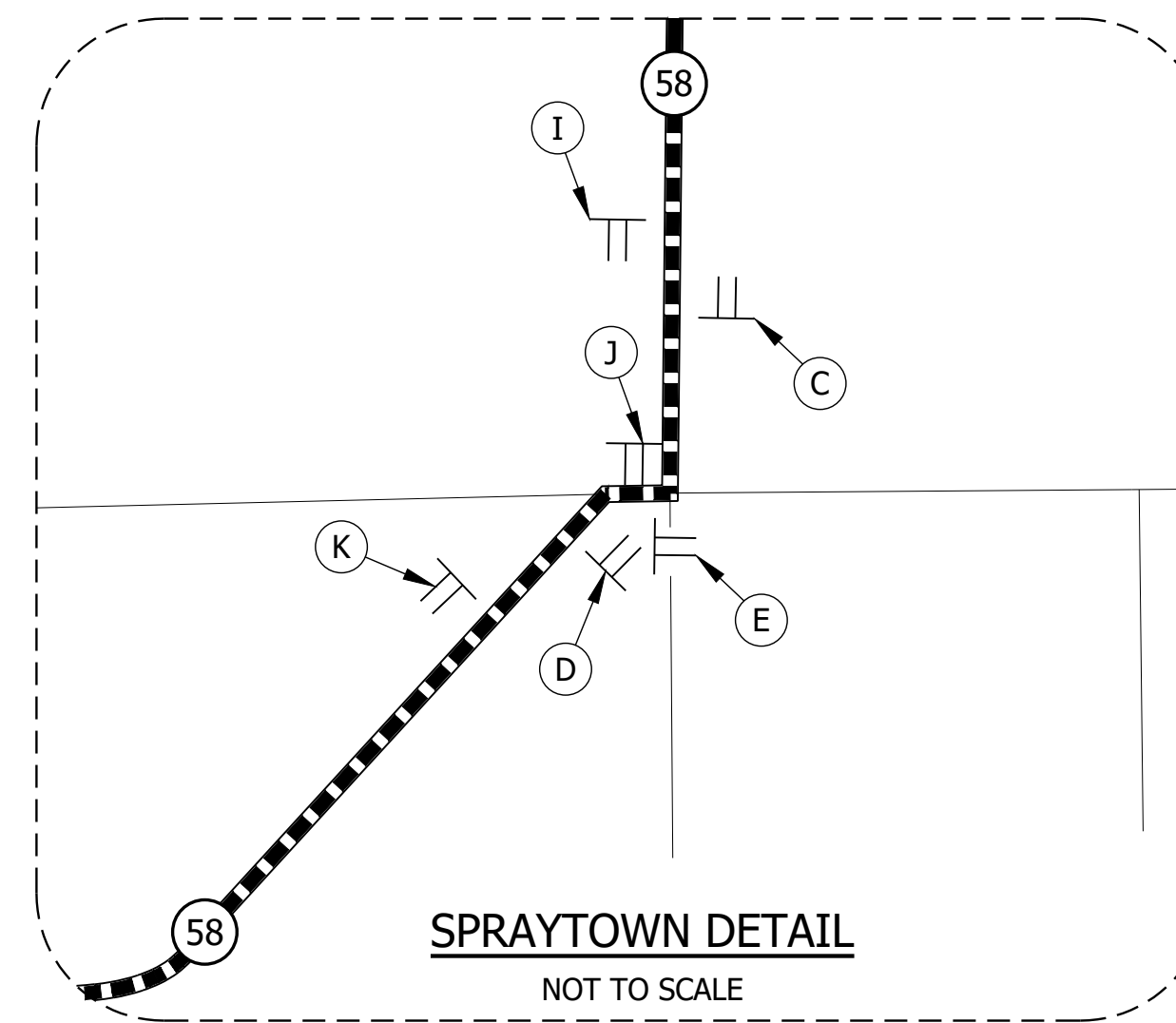
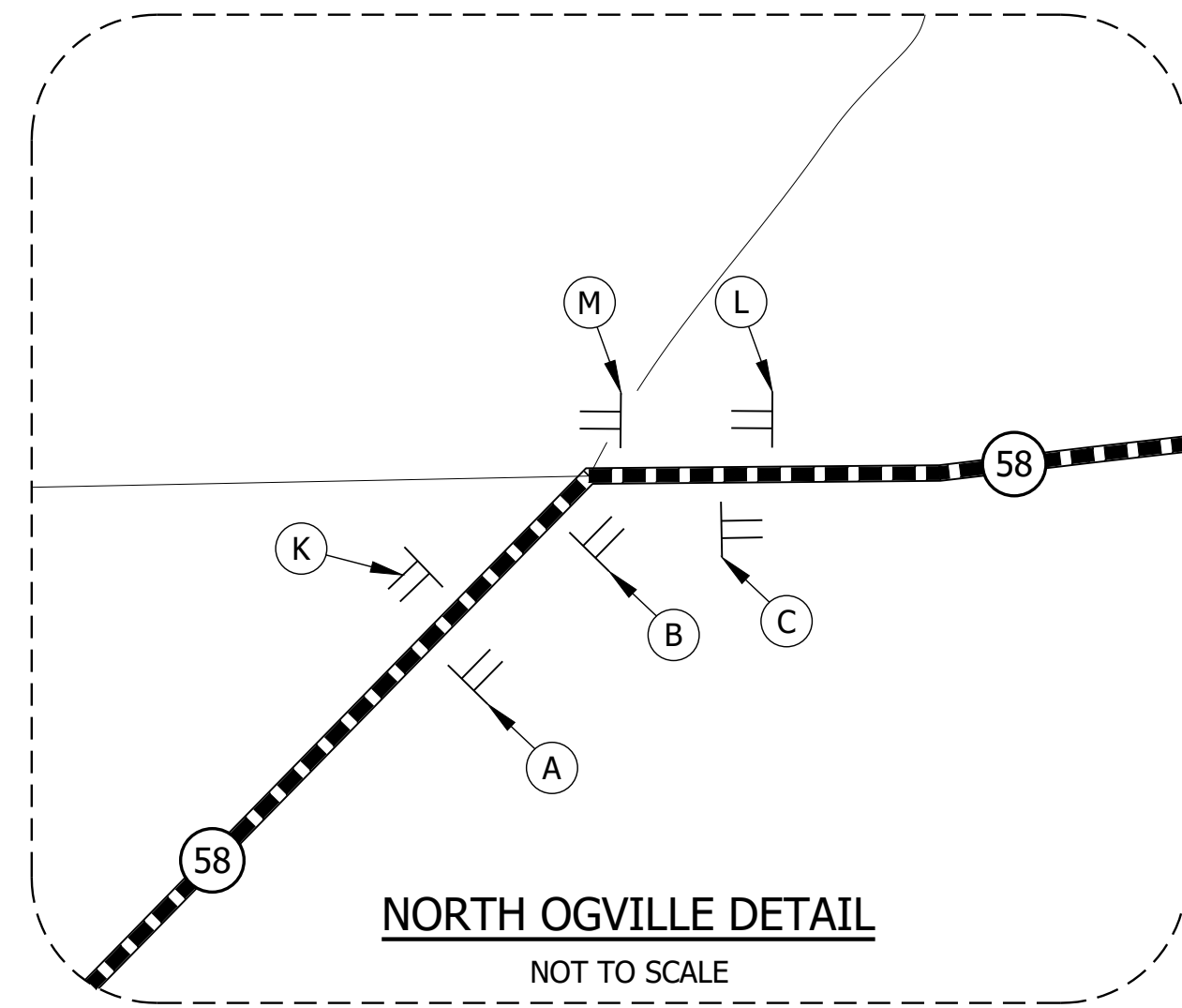

LEGEND

- ① 24 LFT. OF TYPE III-B BARRICADES, STAGGERED WITH ROAD CLOSURE SIGN ASSEMBLY R11-4.
- ② 24 LFT. OF TYPE III-A BARRICADES WITH ROAD CLOSURE SIGN ASSEMBLY R11-2.
- DETOUR ROUTE
- || SIGN ASSEMBLY

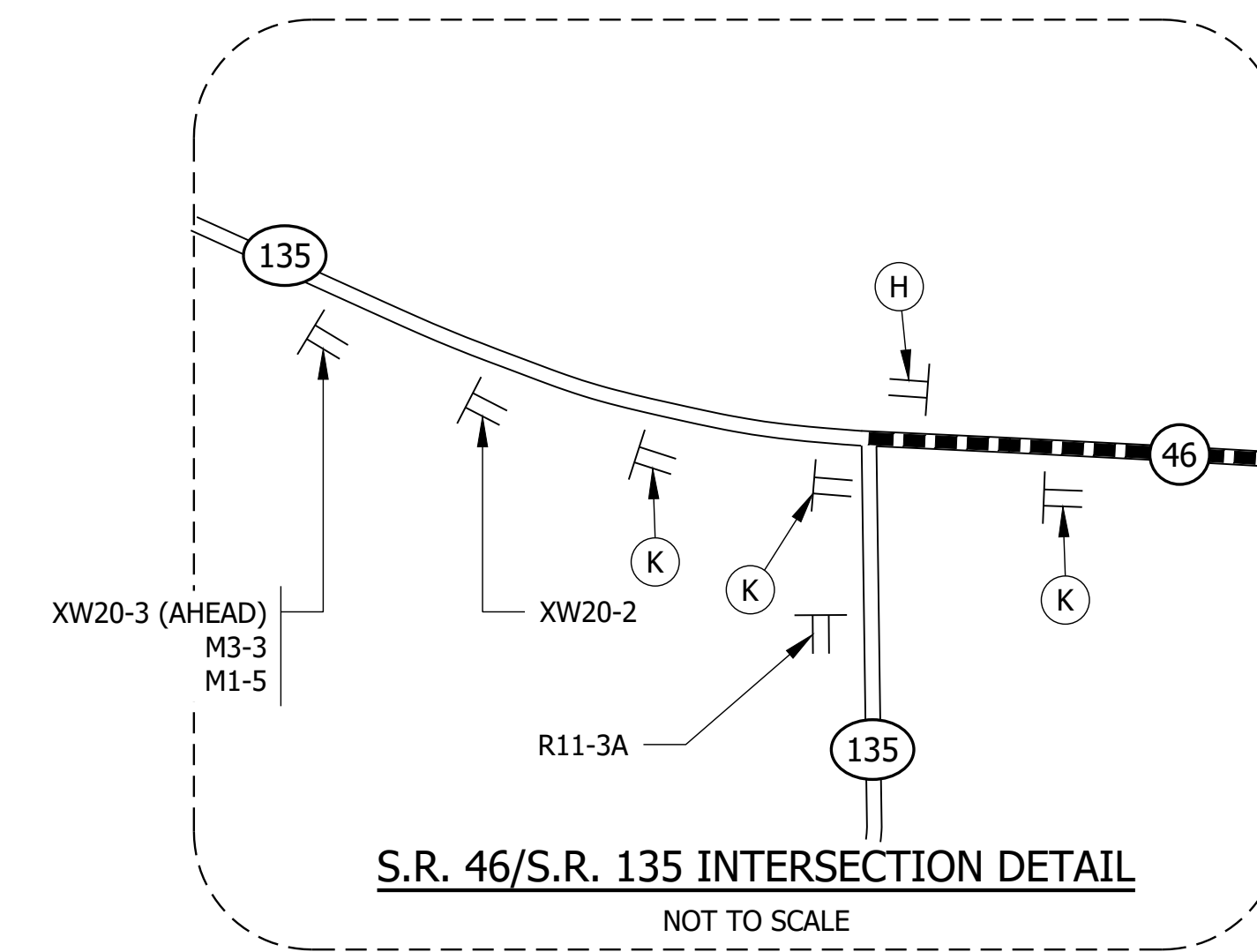
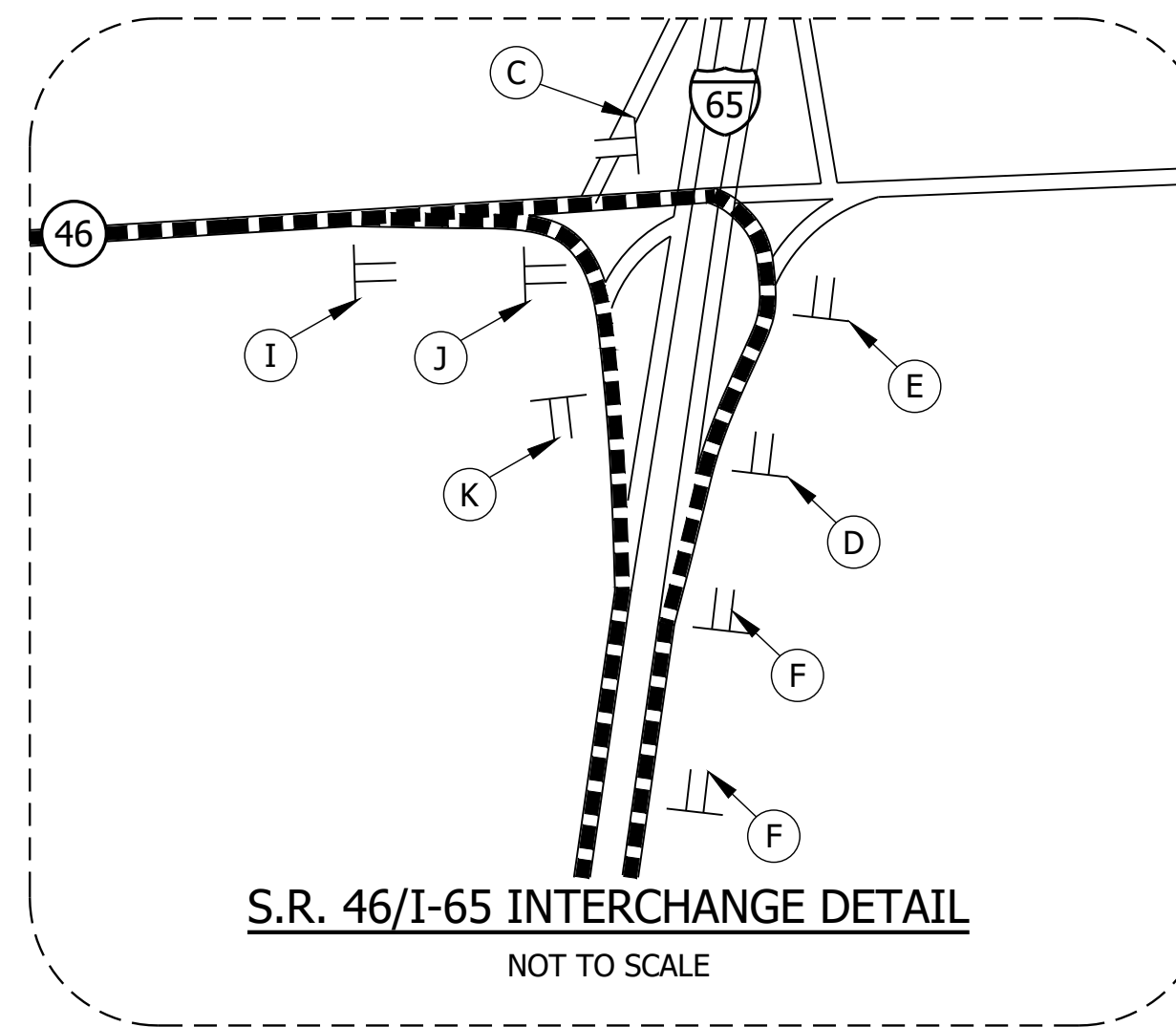
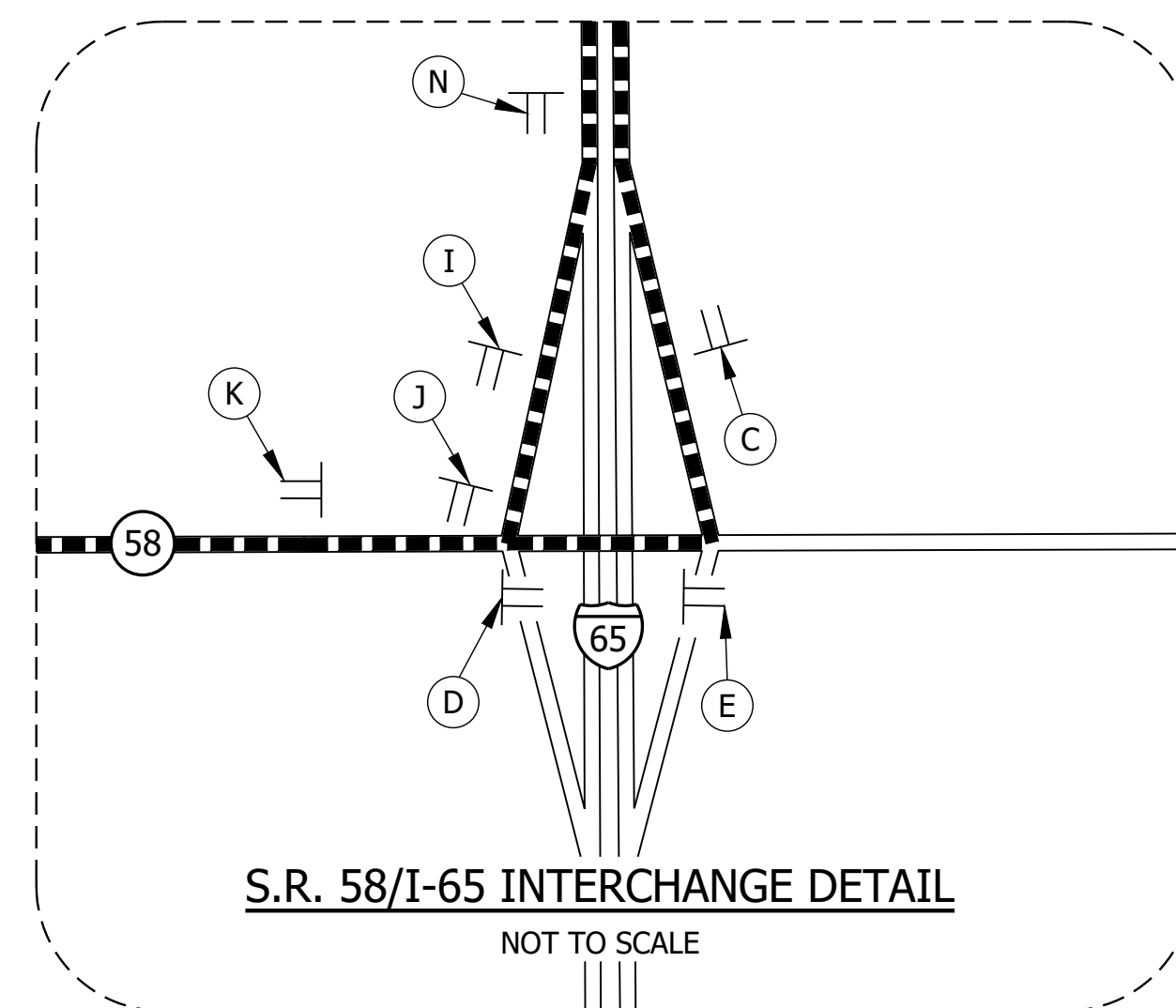
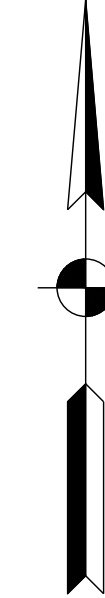

F:\4546-1801032_S.R.135\50 Plans\30 Sheet Drawings\10 Bridge Sheets\S-MOT-DETOUR-01.DWG - Layout2
 September 4, 2020 11:30:50 AM / sjohnson
 September 4, 2020 2:24:15 PM / Stacey Johnson

File Name:
 Modified / By:
 Plotted / By:

PRELIMINARY

RECOMMENDED FOR APPROVAL _____	
DESIGNED: SSB	DRAWN: SEJ
CHECKED: BJM	CHECKED: SSB

INDIANA
DEPARTMENT OF TRANSPORTATION

MAINTENANCE OF TRAFFIC

HORIZONTAL SCALE	BRIDGE FILE
1" = 5000' UNLESS NOTED	N/A
VERTICAL SCALE	DESIGNATION
	1801032
	SHEET
	6 of 16
CONTRACT	PROJECT
B-41458	1801032

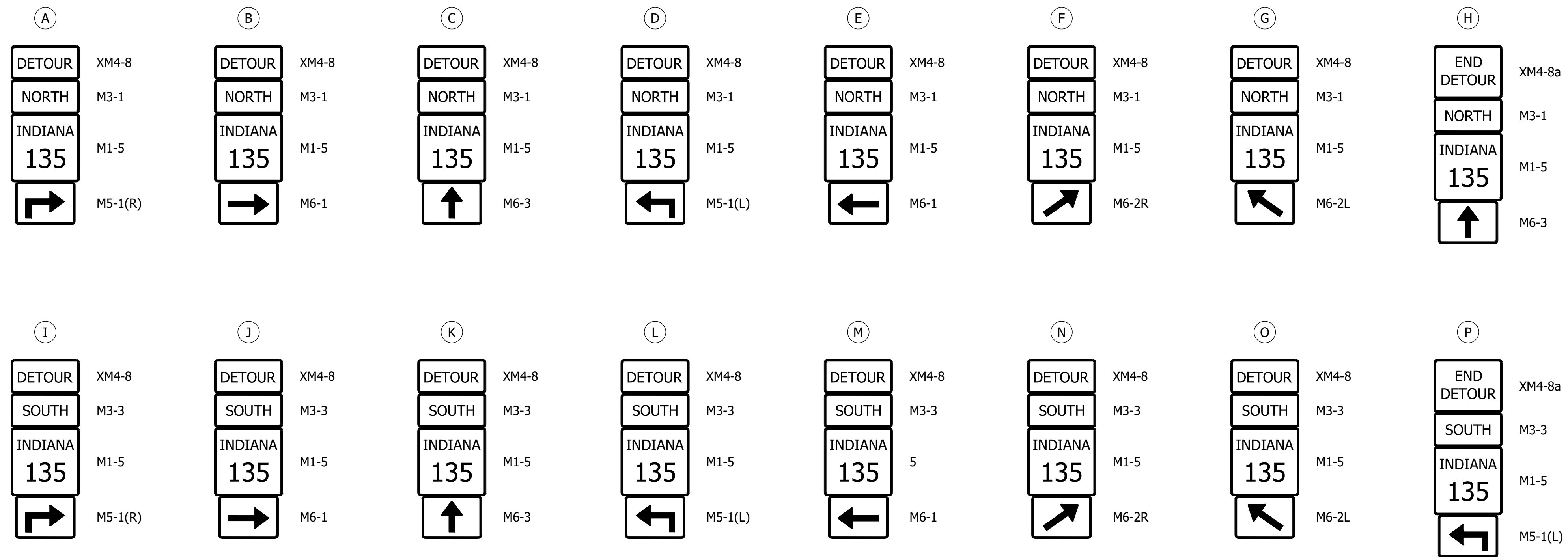

CONSTRUCTION SIGN SCHEDULE				
SIGN NO.	DESCRIPTION	SIZE (FT.)	TYPE	EST. QTY.
XG20-5	S.R.135 CLOSED ON OR AFTER XX	5 X 3	A	2
XW20-2	DETOUR AHEAD	4 X 4	A	2
XW20-3	ROAD CLOSED XXXX	4 X 4	A	14
M3-1	CARDINAL DIRECTION (NORTH)	2 X 1	B	1
M3-3	CARDINAL DIRECTION (SOUTH)	2 X 1	B	1
M1-5	STATE ROUTE SIGN (135)	2.5 X 2	B	2
R11-2	ROAD CLOSED	4 X 2.5	-	2
R11-3A	ROAD CLOSED XX MILES	5 X 2.5	-	2
R11-4	ROAD CLOSED TO THRU TRAFFIC	5 X 2.5	-	2
			TOTAL TYPE "A" SIGNS	18
			TOTAL TYPE "B" SIGNS	4
			ROAD CLOSURE SIGN ASSEMBLIES	6

DETOUR ROUTE MARKER ASSEMBLIES: 59 REQ'D
 TYPE III-A BARRICADES: 48 LFT.
 TYPE III-B BARRICADES: 48 LFT.

* DETOUR ROUTE MARKER ASSEMBLIES SHALL BE IN ACCORDANCE WITH STD. DWG. 801-TCDT-04.

* TYPE B CONSTRUCTION WARNING LIGHTS SHALL BE USED WITH ALL SIGNS LOCATED ON BARRICADES AND AS SHOWN. TYPE A CONSTRUCTION WARNING LIGHTS SHALL BE USED ON ALL OTHER CONSTRUCTION SIGNS. (NOT PAY ITEMS.)

* TWO XG20-5 SIGNS TO BE PLACED AS DIRECTED BY THE ENGINEER.

LEGEND

- ① 24 LFT. OF TYPE III-B BARRICADES, STAGGERED WITH ROAD CLOSURE SIGN ASSEMBLY R11-4.
- ② 24 LFT. OF TYPE III-A BARRICADES WITH ROAD CLOSURE SIGN ASSEMBLY R11-2.
- DETOUR ROUTE
- ⊥ SIGN ASSEMBLY

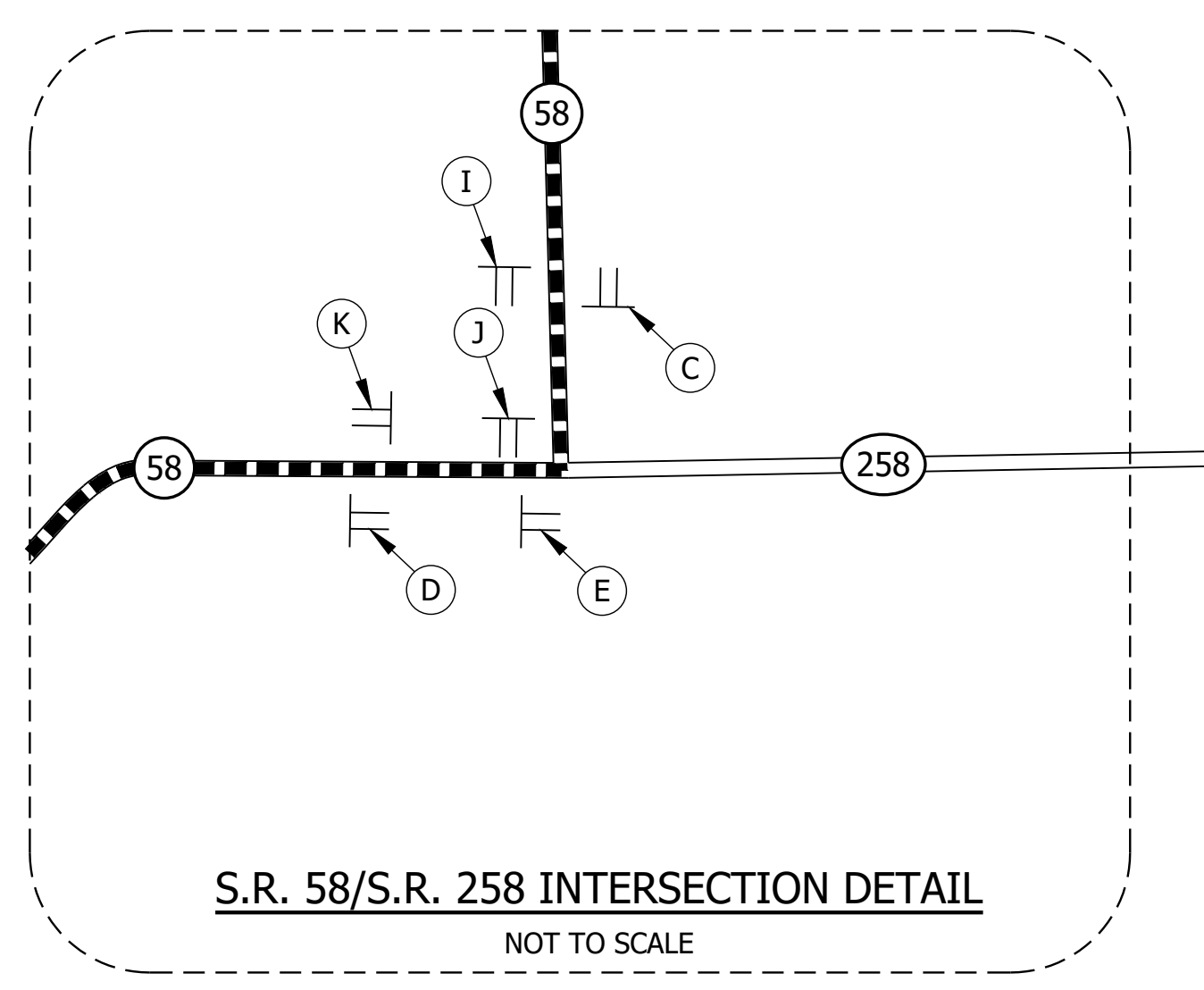
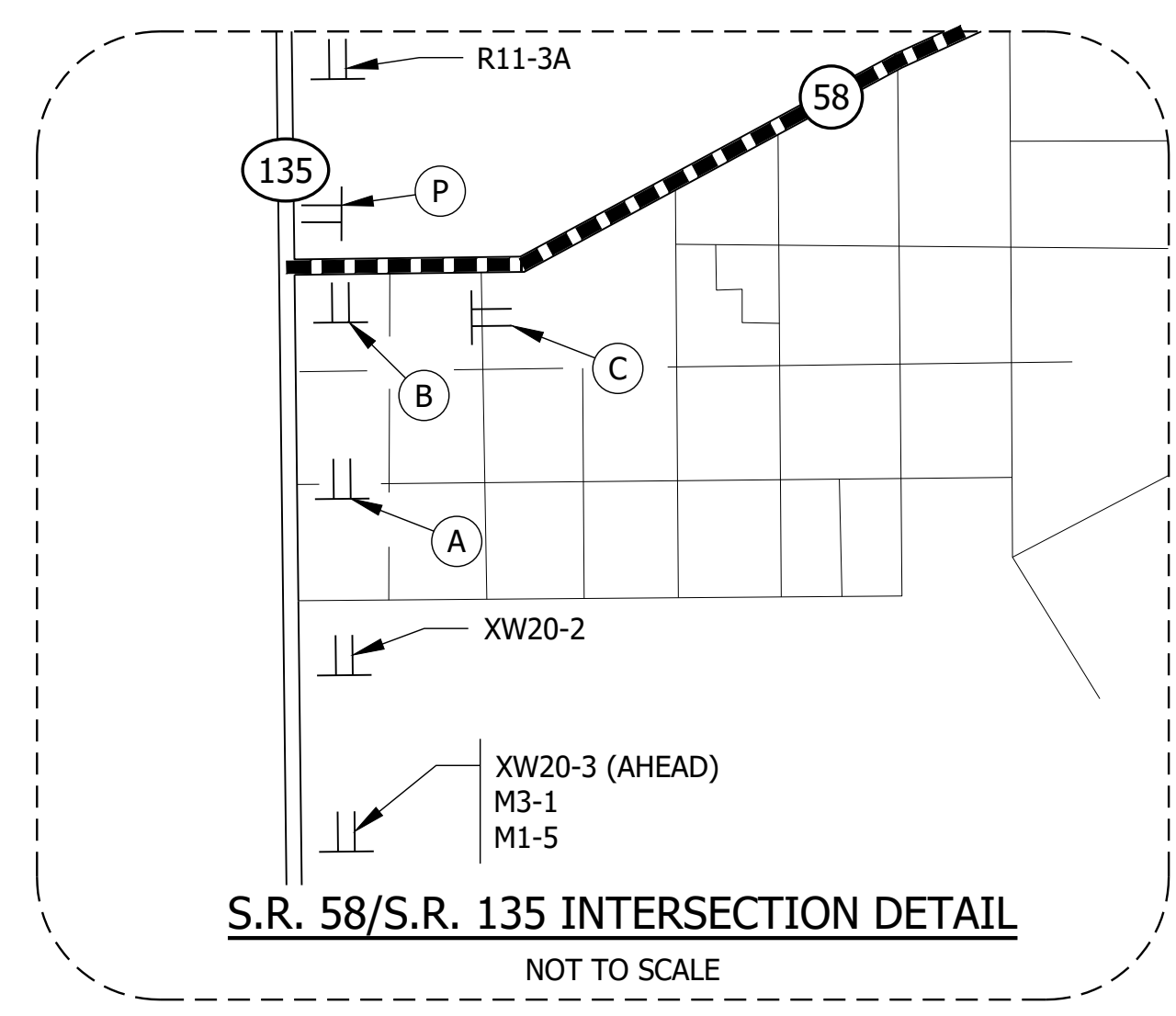

File Name: F:\4546-1801032_S.R.135SmSrv50 Plans\30 Sheet Drawings\10 Bridge Sheets\S-MOT-DETOUR-01.DWG - Layout3
 Modified / By: September 4, 2020 11:30:50 AM / sphinson
 Plotted / By: September 4, 2020 2:24:20 PM / Stacey Johnson

PRELIMINARY	RECOMMENDED FOR APPROVAL _____ DATE _____	INDIANA DEPARTMENT OF TRANSPORTATION MAINTENANCE OF TRAFFIC	HORIZONTAL SCALE 1" = 5000' UNLESS NOTED	BRIDGE FILE N/A
	DESIGNED: SSB DRAWN: SEJ		VERTICAL SCALE	DESIGNATION 1801032
	CHECKED: BJM CHECKED: SSB		CONTRACT B-41458	SHEET 7 of 16
			PROJECT 1801032	

LEGEND:

- 1 GILBERT RAY AND SHARON KAY CARPENTER
- 2 LLOYD J., LARRY K., JERRY R., PAUL E., JAMES AND ROBERT ZIKE, JOANN CHEEK AND SHARON KIRTS
- 3 TERRY V. AND JUDITH ANDERSON
- A XX TONS OF REVETMENT RIPRAP ON XX SYS OF GEOTEXTILES FOR RIPRAP TYPE XX
- B XX TONS OF REVETMENT RIPRAP ON XX SYS OF GEOTEXTILES FOR RIPRAP TYPE XX

CURVE DATA - CURVE NO. 1

P.I. STA. = 11+24.89 "A"
 Δ = 10°50'47"
 R = 795.00'
 L = 150.50'
 T = 75.47'
 S.E. = 3.5%

CURVE DATA - CURVE NO. 3

P.I. STA. = 15+41.86 "A"
 Δ = 27°24'42"
 R = 173.00'
 L = 82.77'
 T = 42.19'
 S.E. = 7.2%

CURVE DATA - CURVE NO. 2

P.I. STA. = 14+61.08 "A"
 Δ = 18°18'27"
 R = 243.60'
 L = 77.84'
 T = 39.25'
 S.E. = 7.2%

SECTION 1, T-6-N, R-3-E
 PERSHING TOWNSHIP
 JACKSON COUNTY

ALL R/W DESCRIBED FROM LINE "A".
 LINE "A" TO BE CONSTRUCTED.
 * INDICATES R/W MARKER REQ'D.

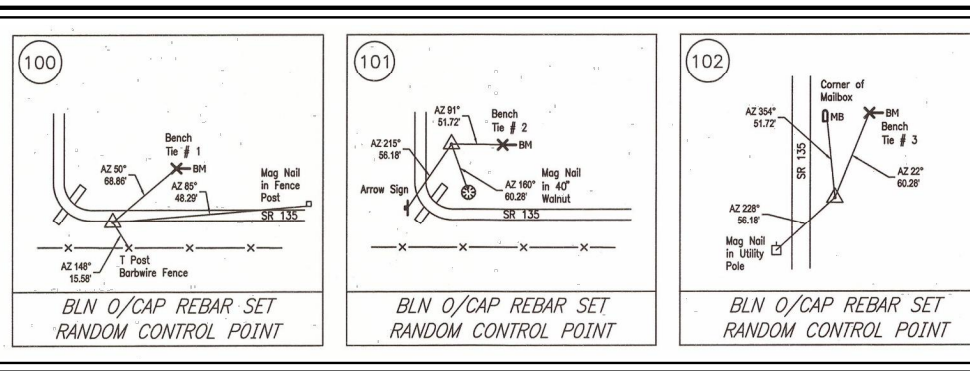
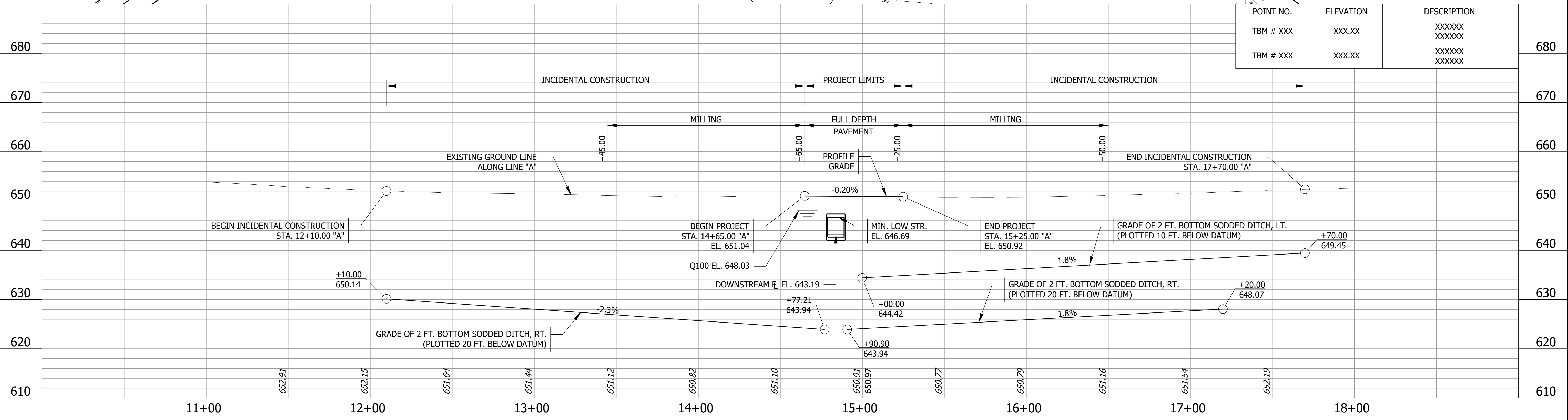
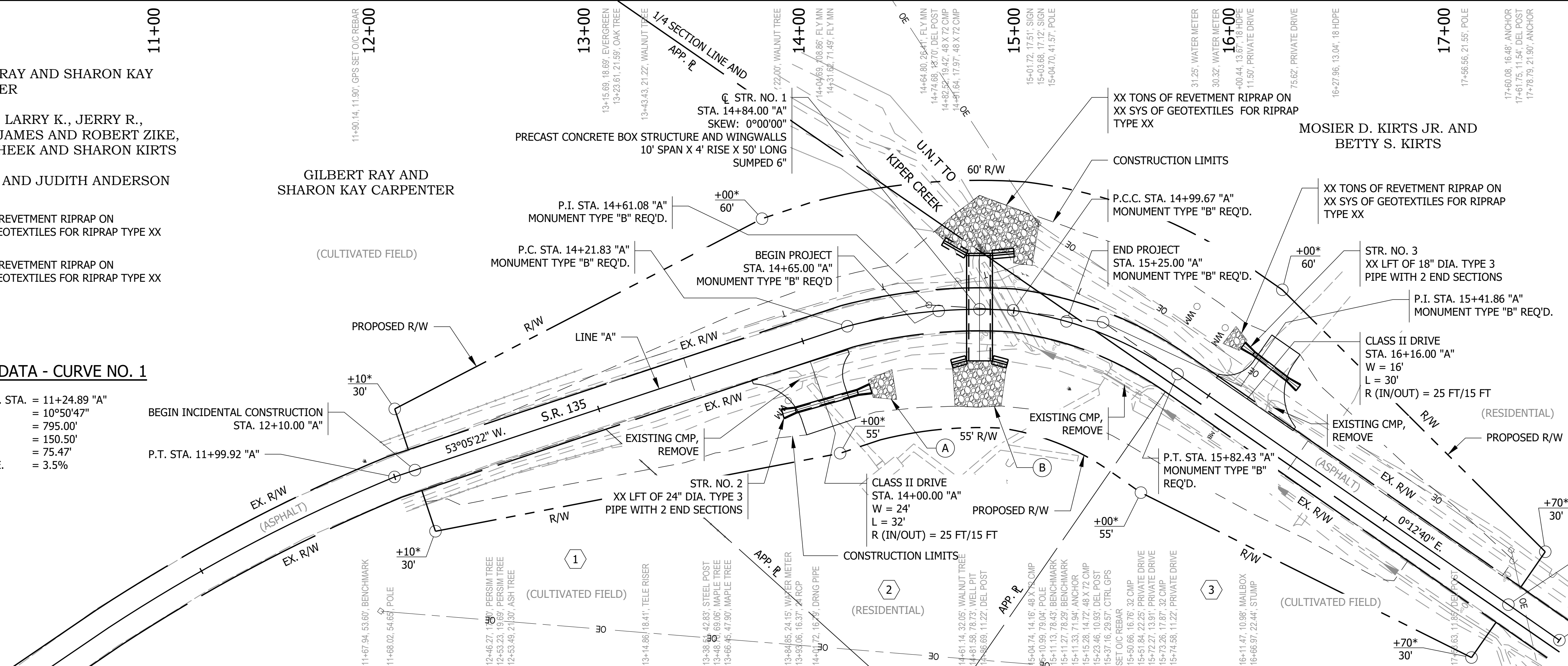

PRELIMINARY	RECOMMENDED FOR APPROVAL _____		DESIGN ENGINEER _____ DATE _____	
	DESIGNED: ZZH	DRAWN: SEJ		
	CHECKED: BJM	CHECKED: ZZH		
	INDIANA DEPARTMENT OF TRANSPORTATION		PLAN AND PROFILE	
HORIZONTAL SCALE 1" = 30'-0" UNLESS NOTED		BRIDGE FILE N/A		
VERTICAL SCALE 1" = 10'-0" UNLESS NOTED		DESIGNATION 1801032		
		SHEET 8 of 16		
CONTRACT B-41458		PROJECT 1801032		

File Name: F:\4546-1801032_SRT135SmStr30 Sheet Drawings\10 Bridge Sheets\PLAN-PROFILE-01.dwg - Layout1
 Modified / By: September 3, 2020 4:42:25 PM / sjohnson
 Plotted / By: September 4, 2020 2:24:46 PM / Stacey Johnson

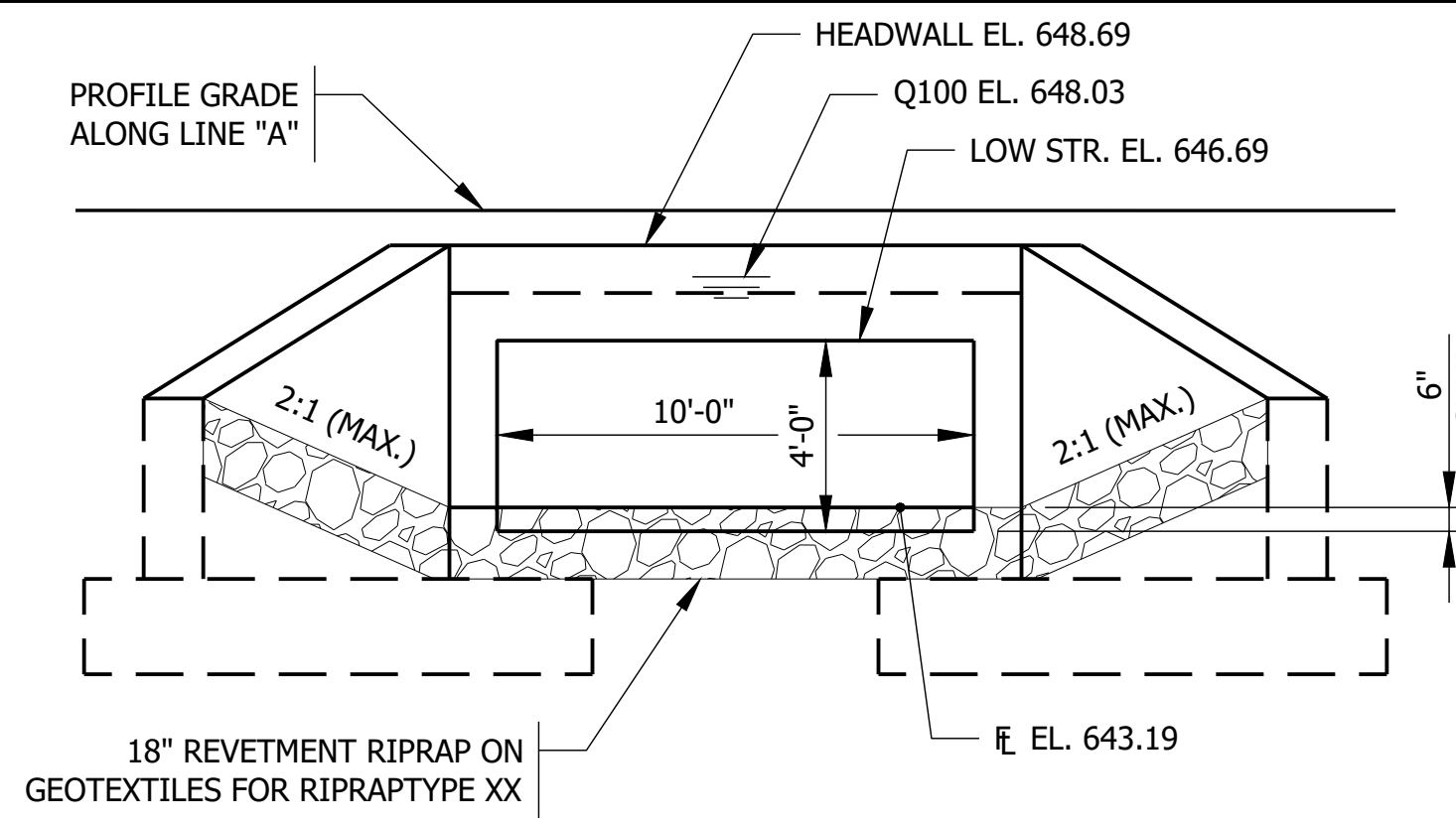

OUTLET ELEVATION
SCALE: 1/4" = 1'-0"

SOIL PARAMETERS FOR WINGWALL DESIGN	VALUE
FACTORED BEARING RESISTANCE	—
NOMINAL BEARING CAPACITY	—
RESISTANCE FACTOR	—
FRICTION ANGLE OF THE BACKFILL	—
FRICTION FACTOR OF THE FOUNDATION SOIL	—
ANGLE OF INTERNAL FRICTION OF THE FOUNDATION SOIL	—
ULTIMATE ADHESION BETWEEN FOUNDATION SOIL AND THE POURED CONCRETE FOOTING	—
SOIL COHESION	—

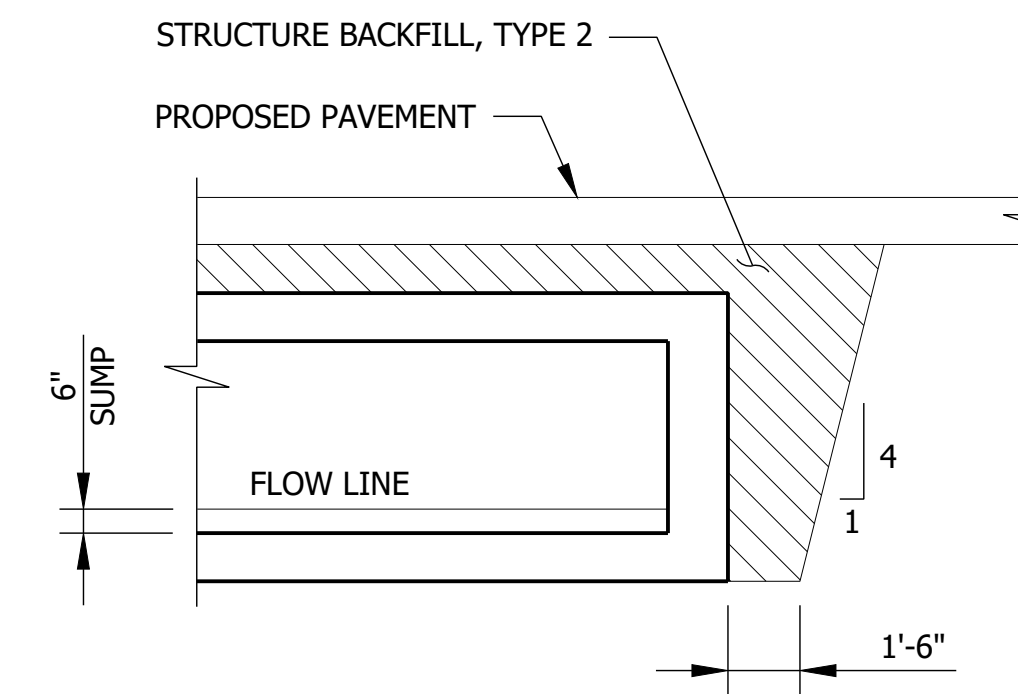

STRUCTURE BACKFILL AT STRUCTURE
SCALE: 1/4" = 1'-0"

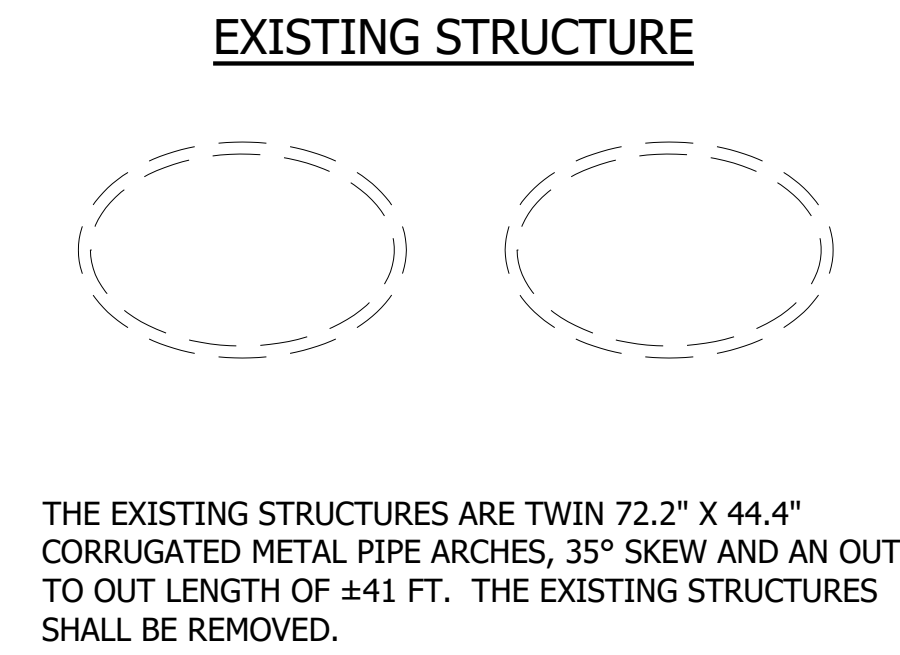

EXISTING STRUCTURE

THE EXISTING STRUCTURES ARE TWIN 72.2" X 44.4" CORRUGATED METAL PIPE ARCHES, 35° SKEW AND AN OUT TO OUT LENGTH OF ±41 FT. THE EXISTING STRUCTURES SHALL BE REMOVED.

DESIGN DATA

STRUCTURE DESIGNED FOR HL-93 LOADING, IN ACCORDANCE WITH THE AASHTO LRFD BRIDGE DESIGN SPECIFICATIONS, EIGHTH EDITION, 2017, AND SUBSEQUENT INTERIM. DEAD LOAD INCREASED 35 PSF FOR FUTURE WEARING SURFACE.

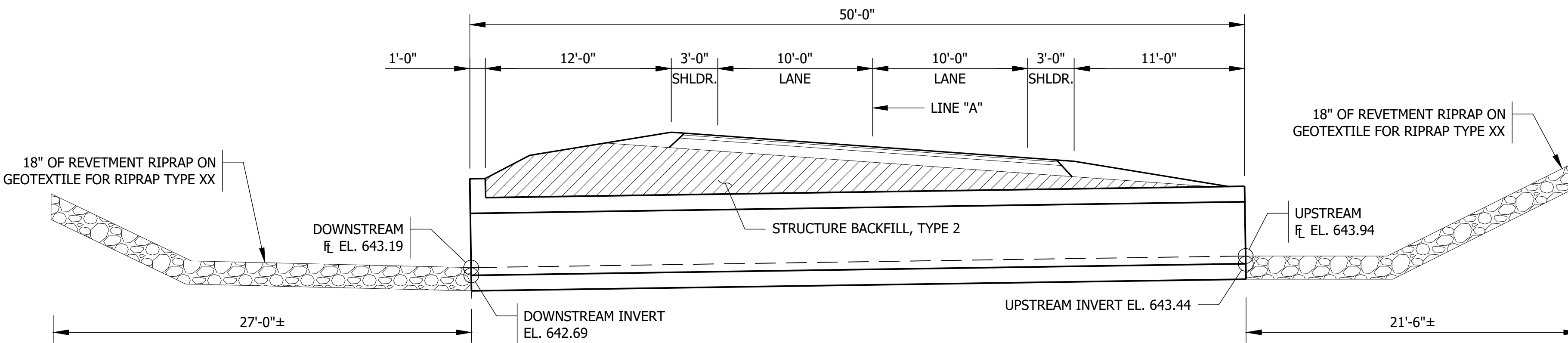

TYPICAL SECTION ALONG Q STRUCTURE
SCALE: 3/16" = 1'-0"

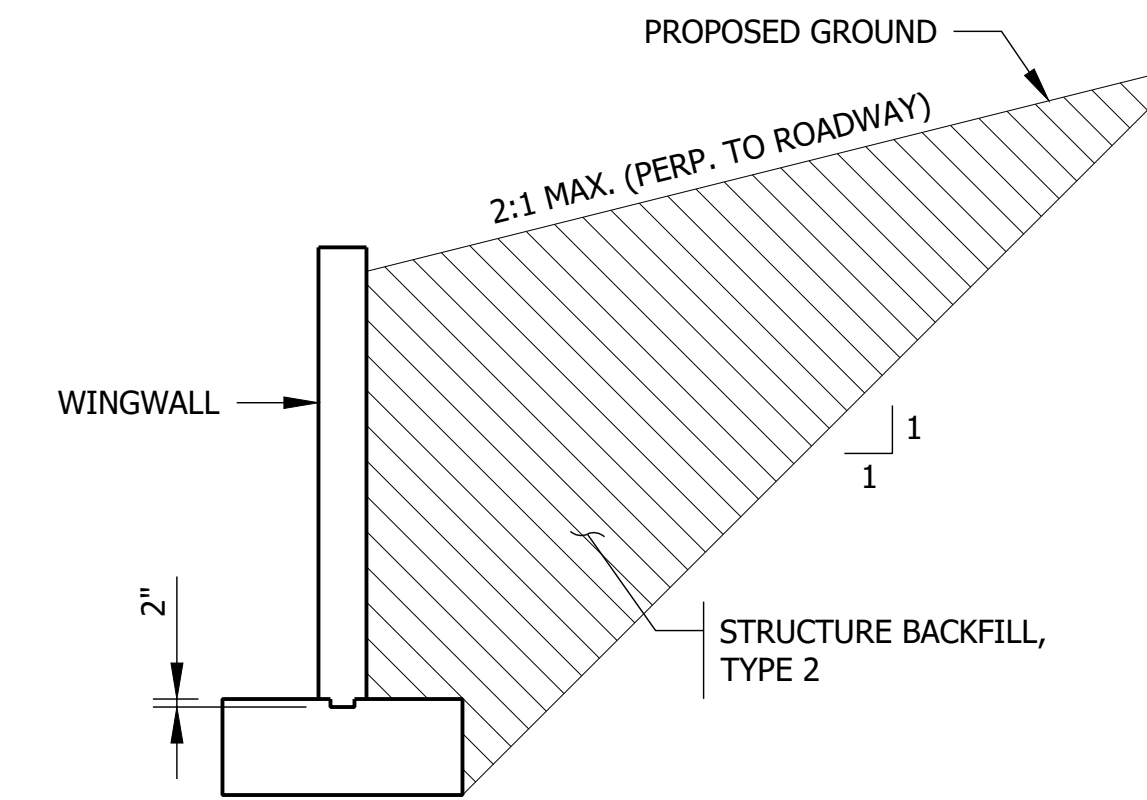

STRUCTURE BACKFILL AT WINGWALL
SCALE: 1/4" = 1'-0"

HYDRAULIC DATA

DRAINAGE AREA:	108 ACRE
Q100 DISCHARGE:	221 CFS
Q100 ELEVATION:	648.03 FT.
APPROXIMATE SKEW:	0°00'00"
REQUIRED WATERWAY AREA (BELOW Q100 ELEVATION)	35 SFT
PROPOSED WATERWAY AREA (BELOW Q100 ELEVATION)	0 SFT
PROPOSED ROAD OVERFLOW AREA	35 SFT
PROPOSED VELOCITY	5.4 FT./SEC.
PROPOSED BACKWATER	0.48 FT.
MINIMAL LOW STRUCTURE ELEVATION	646.69 FT.
EXISTING GROSS WATERWAY AREA (BELOW Q100 ELEVATION)	29.4 SFT
EXISTING ROAD OVERFLOW AREA	0 SFT
EXISTING VELOCITY	5.5 FT./SEC.
EXISTING BACKWATER	0.56 FT.
EXISTING LOW STRUCTURE	648.24 FT.

- NOTES:**
- BOTTOM OF FOOTING SHALL BE 4'-0" BELOW THE FLOWLINE.

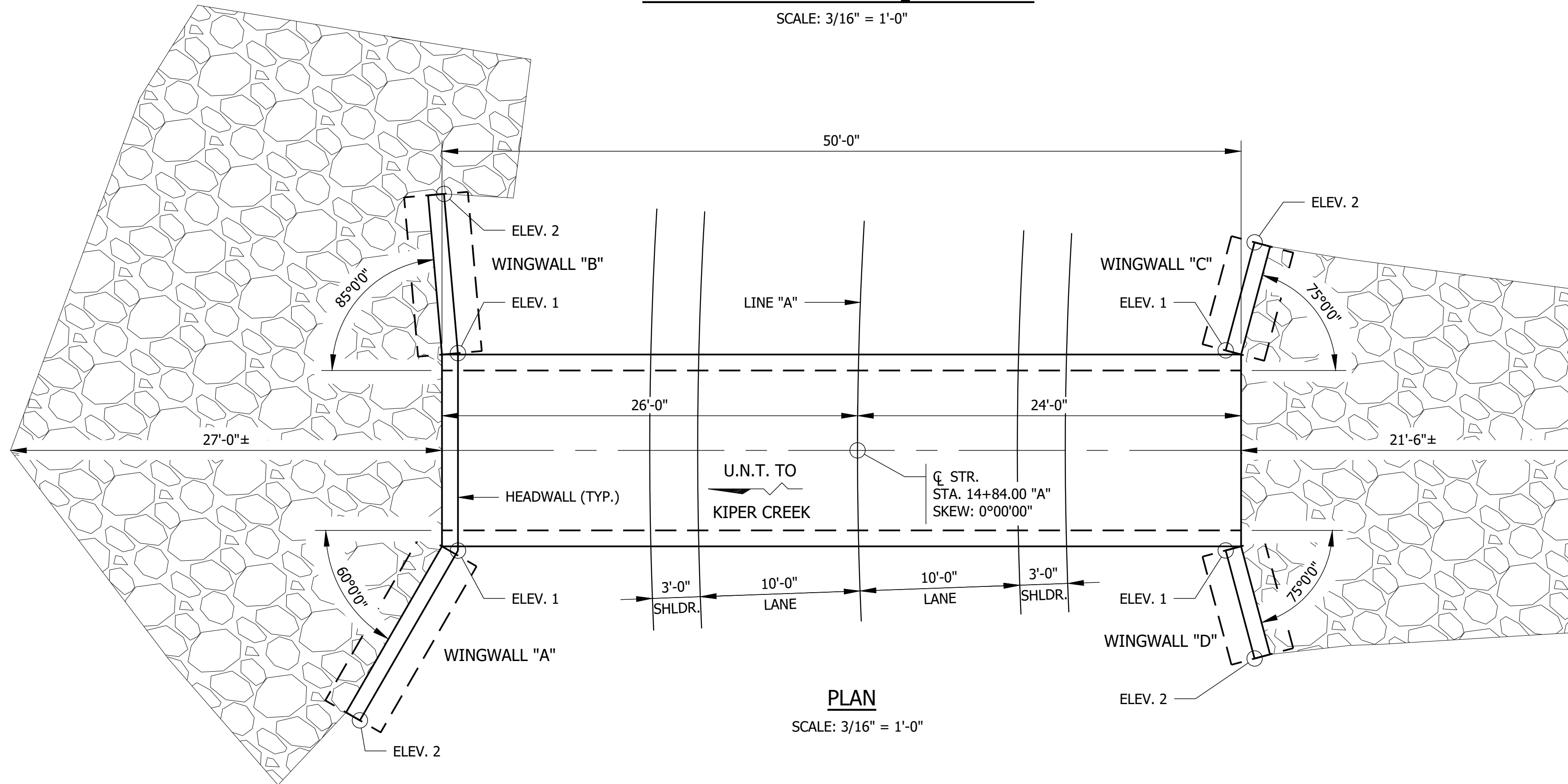

PLAN
SCALE: 3/16" = 1'-0"

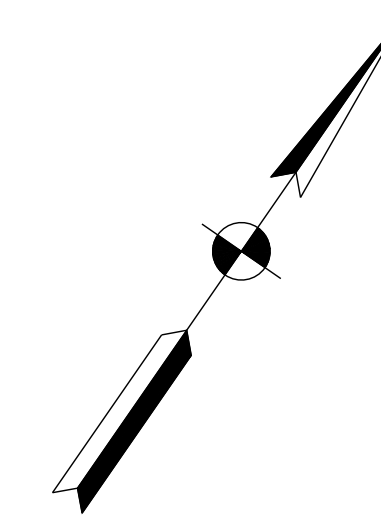

WINGWALL TABLE

WING	"L"	ELEV. 1	ELEV. 2	AREA (SFT)
"A"	12'	.	.	.
"B"	10'	.	.	.
"C"	7'	.	.	.
"D"	7'	.	.	.

ESTIMATED QUANTITY OF HEADWALLS: XXXX SFT.

REINFORCED CONCRETE
BOX STRUCTURE
SPAN: 10'-0"
RISE: 4'-0"
S.R. 135 OVER U.N.T. TO
KIPER CREEK
JACKSON COUNTY

File Name: F:\4546-1801032_SRR135SmStr50 Plans\30 Sheet Drawings\10 Bridge Sheets\S-GENPLAN-01.dwg - Layout1
August 10, 2020 11:10:09 AM / sbath
September 4, 2020 2:25:21 PM / Stacey Johnson

Modified / By:
Plotted / By:

PRELIMINARY

RECOMMENDED FOR APPROVAL	DESIGN ENGINEER	DATE
DESIGNED: ZZH	DRAWN: SEJ	
CHECKED: BJM	CHECKED: ZZH	

INDIANA
DEPARTMENT OF TRANSPORTATION

GENERAL PLAN

HORIZONTAL SCALE	BRIDGE FILE
AS NOTED	N/A
VERTICAL SCALE	DESIGNATION
	1801032
	SHEET
	10 of 16
CONTRACT	PROJECT
B-41458	1801032