

## **Glossary**



---

## **Illustrations**

---

The following illustrations are included to familiarize the assessor with construction characteristics and formulas for calculating the square foot area:

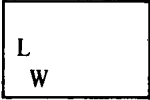
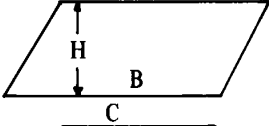
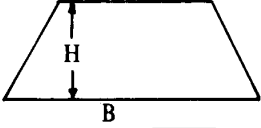
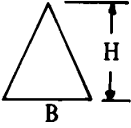
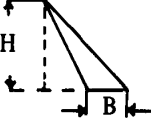
Area Calculations

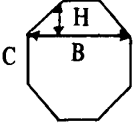
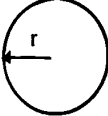
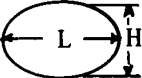
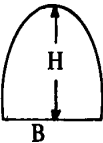
SQUARE		AREA = L x W
RECTANGLE		AREA = L x W
PARALLELOGRAM		AREA = H x B
TRAPEZOID		AREA = H x 1/2 (B+C)
TRIANGLE		AREA = 1/2 H x B
TRIANGLE		AREA = 1/2 H x B
REGULAR POLYGONS	GENERAL	AREA = 1/2 SUM OF SIDES x INSIDE RADIUS
HEXAGON		AREA = H x (B+C)
OCTAGON		AREA = H x (B+C) + C x B
CIRCLE		AREA = π (3.1416) x r x r
ELLIPSE		AREA = L x H x 0.7854
PARABOLA		AREA = 2/3 x H x B

# Glossary

## Architecture Nomenclature

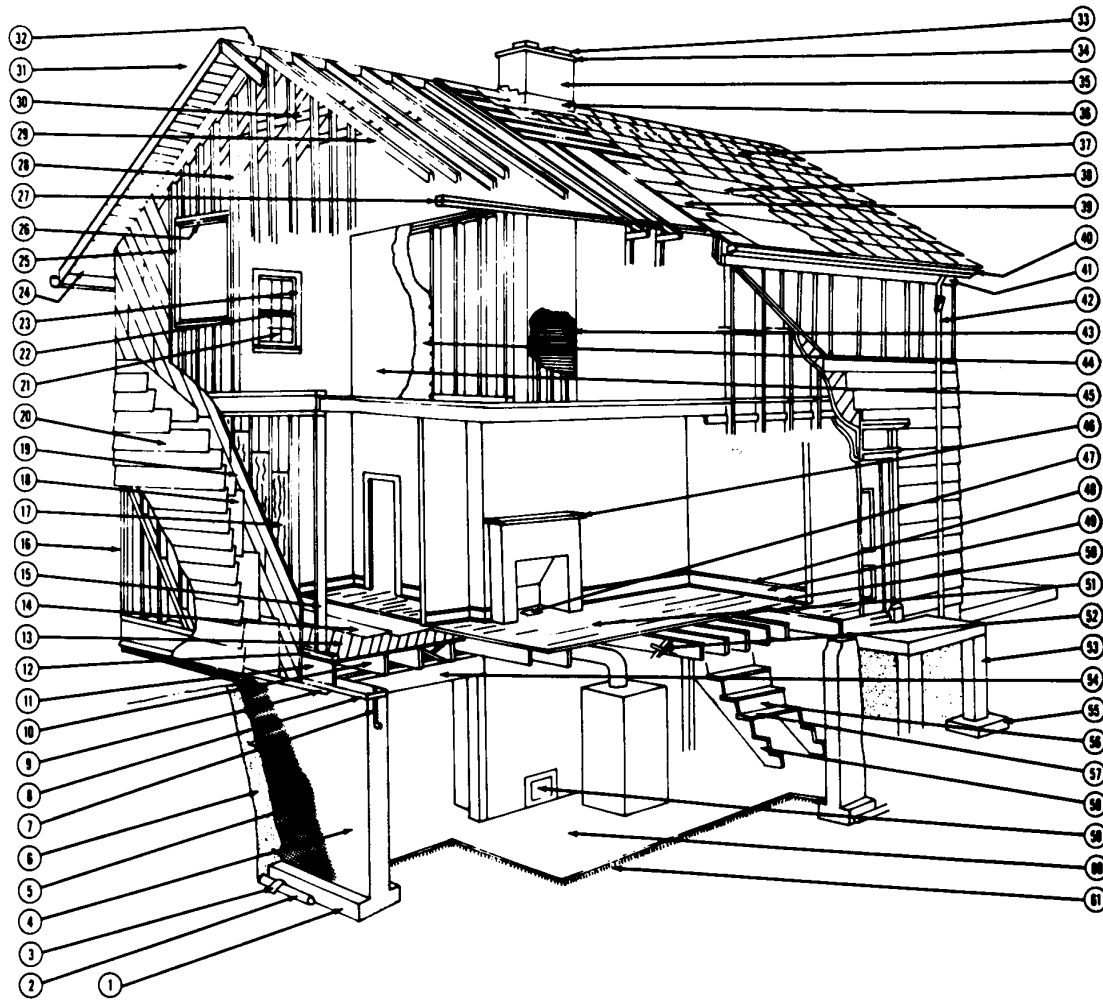

- |                                    |                            |                             |
|------------------------------------|----------------------------|-----------------------------|
| 1. Footing                         | 21. Mullion                | 41. Frieze board            |
| 2. Foundation drain tile           | 22. Muntin                 | 42. Downspout               |
| 3. Felt joint cover                | 23. Window sash            | 43. Laths                   |
| 4. Foundation wall                 | 24. Eave (roof projection) | 44. Wallboard               |
| 5. Dampproofing or weatherproofing | 25. Window jamb trim       | 45. Plaster finish          |
| 6. Backfill                        | 26. Double window header   | 46. Mantel                  |
| 7. Anchor bolt                     | 27. Double plate           | 47. Ash dump                |
| 8. Sill                            | 28. Stud                   | 48. Base top moulding       |
| 9. Termite shield                  | 29. Rafters                | 49. Baseboard               |
| 10. Floor joist                    | 30. Collar beam            | 50. Shoe moulding           |
| 11. Band or box sill               | 31. Gable end of roof      | 51. Finish flooring         |
| 12. Plate                          | 32. Ridge board            | 52. Bridging                |
| 13. Subflooring                    | 33. Chimney pots           | 53. Pier                    |
| 14. Building paper                 | 34. Chimney cap            | 54. Girder                  |
| 15. Wall stud                      | 35. Chimney                | 55. Footing                 |
| 16. Double corner stud             | 36. Chimney flashing       | 56. Riser                   |
| 17. Insulation                     | 37. Roofing shingles       | 57. Tread                   |
| 18. Building paper                 | 38. Roofing felts          | 58. Stringer                |
| 19. Wall sheathing                 | 39. Roof boards            | 59. Cleanout door           |
| 20. Siding                         | 40. Eave trough or gutter  | 60. Concrete basement floor |
|                                    |                            | 61. Cinder fill             |

Building Cross-Sections

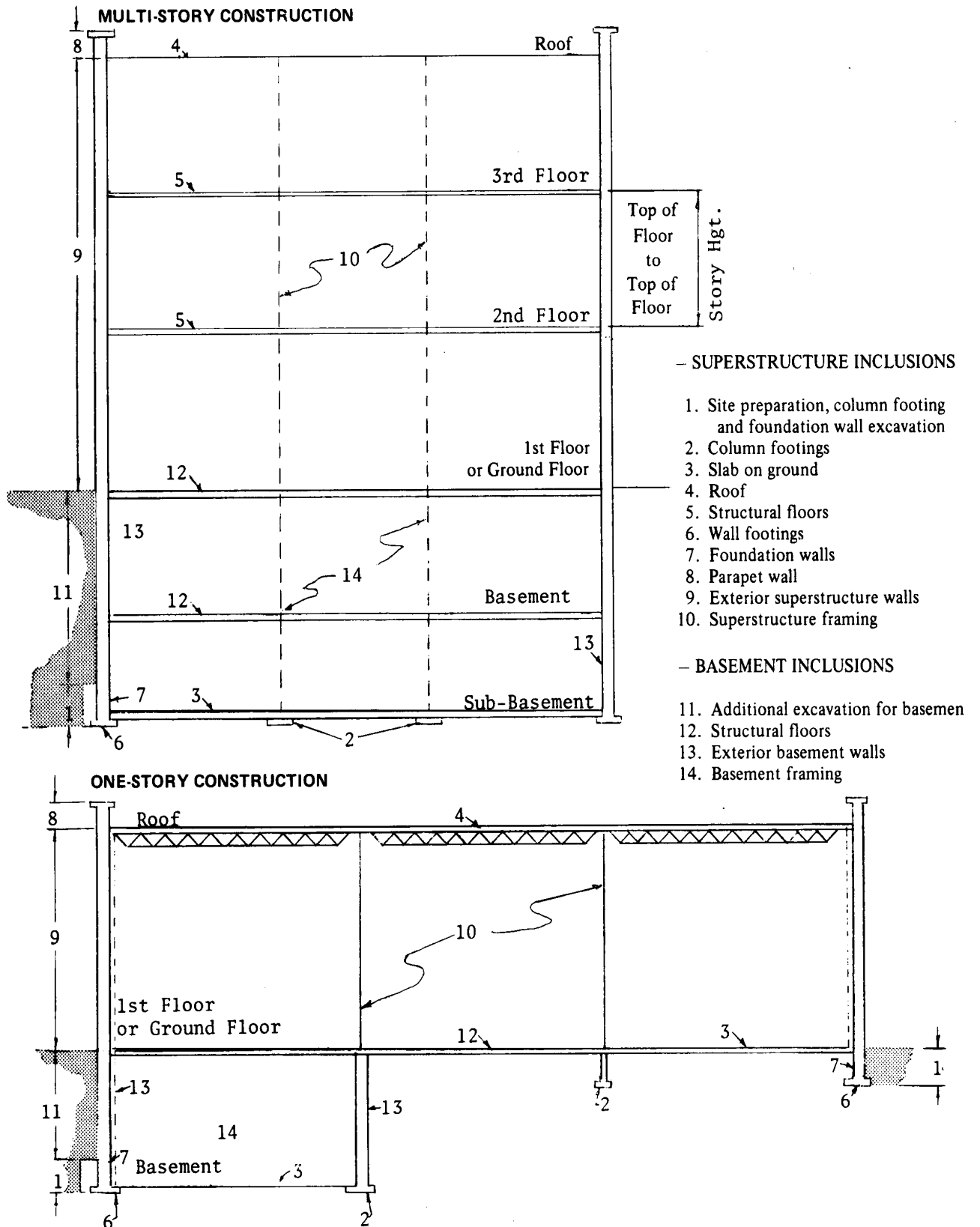

# Glossary

## Occupancy Types

Single Family

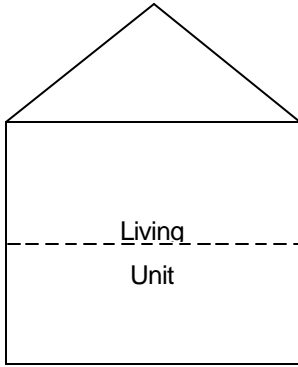

Single Family Conversion (2 families)

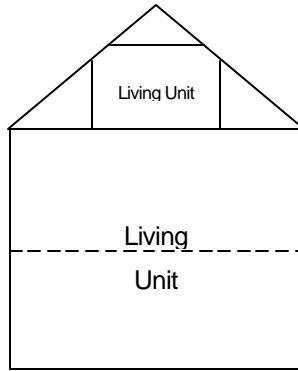

Duplex

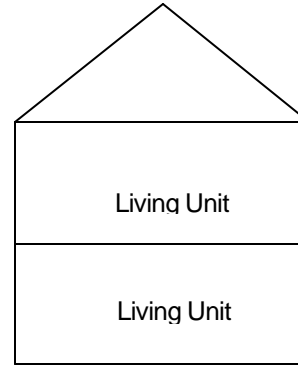

Duplex Conversion (3 families)

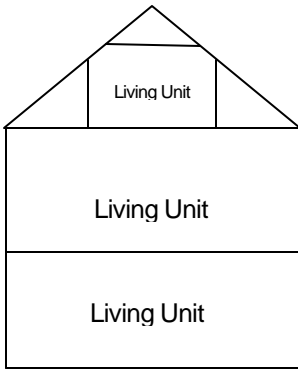

Triplex

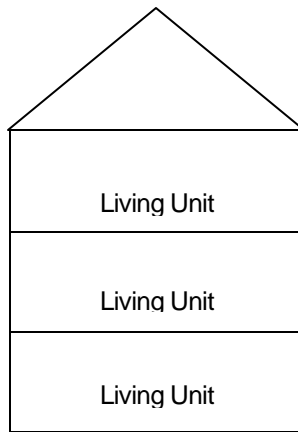

4-Family

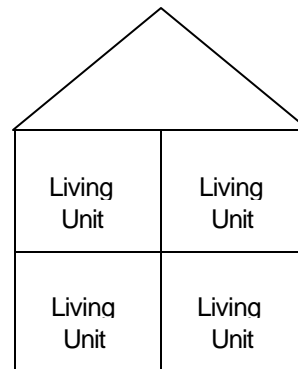

4-Family

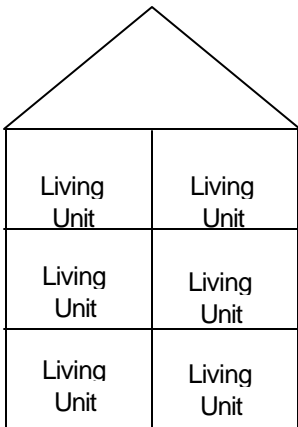

2-Family Row Type (double)

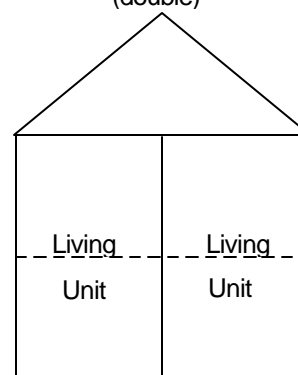

Multi-Family Row Type or apartment (depending on ownership)

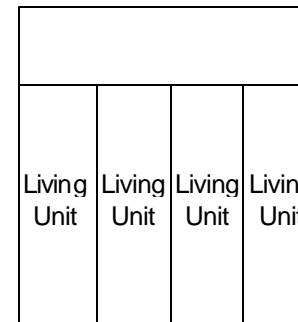

Story Height

1 Story

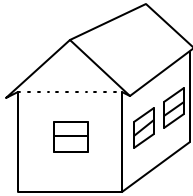

1 Story and Attic

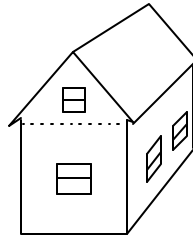

1 Story and Finished Attic

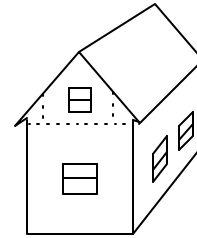

1 ½ Story

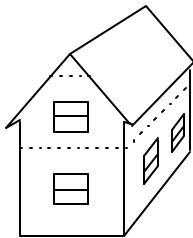

1½ Story

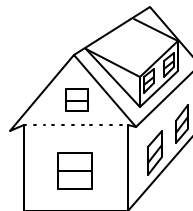

1 ½ Story

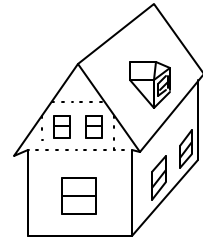

2 Story

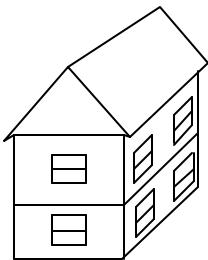

2½ Story

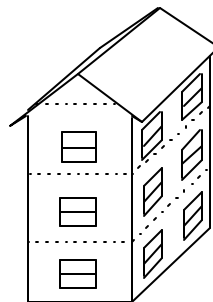

3 Story

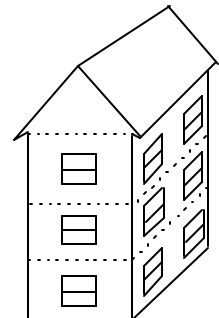

# Glossary

## Modern Height Designs

### Modern Story Height Designs

Parenthetical symbols indicate the most typical uses at that particular level.

- K–Kitchen
- D–Dining Area
- L–Living Area
- F–Family Room
- BR–Bedrooms
- U–Utility Area
- R–Recreation Room
- AG–Attached Garage
- IG–Integral Garage
- BG–Basement Garage

Circled symbols indicate pricing levels:

- B–Basement
- C–Crawl Space
- 1–First Floor
- 2–Upper Floor

Ranch (on slab)

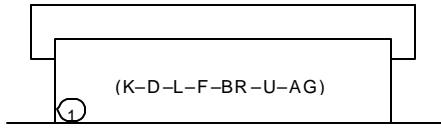

Ranch (over crawl space)

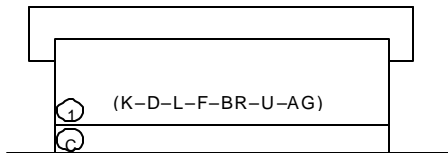

Ranch with Basement

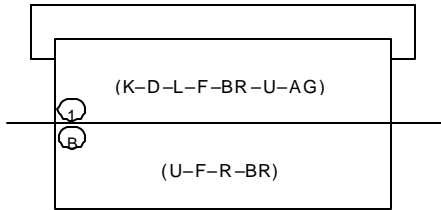

Bi-Level (raised ranch)

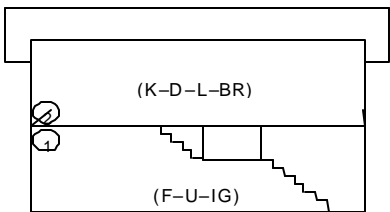

Tri-Level

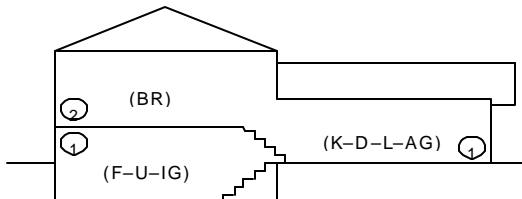

Tri-Level with Basement \*

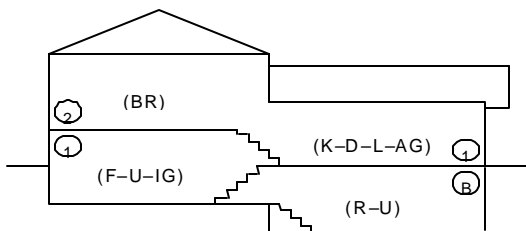

\*totally below grade

Tri-Level with Basement \*

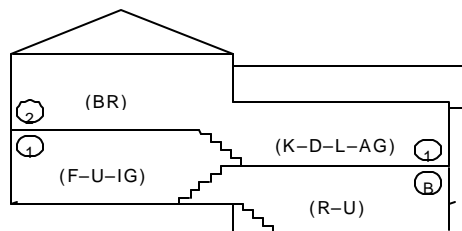

\*partially below grade

Roof Types

Gable

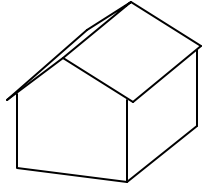

Hip

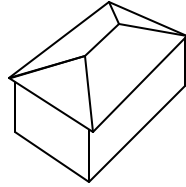

Shed

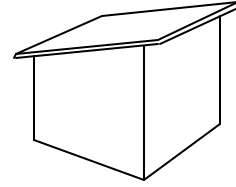

Gambrel

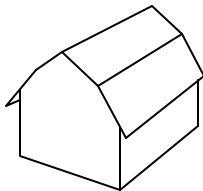

Mansard

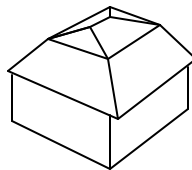

Arched

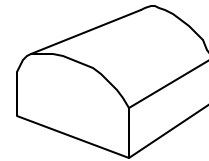

Flat

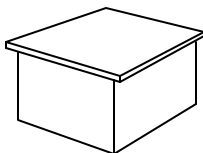

Monitor

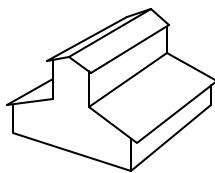

Sawtooth

